

REPRODUCING THESE DRAWINGS BY PRINTING OR COPYING MAY LEAD TO ERRORS. PLEASE REFER TO SCALE BAR. DO NOT SCALE OFF THESE DRAWINGS FOR CONSTRUCTION PURPOSES. IF ANY DISCREPANCIES ARE FOUND, PLEASE CONTACT WESTERN DESIGN ARCHITECTS IMMEDIATELY.

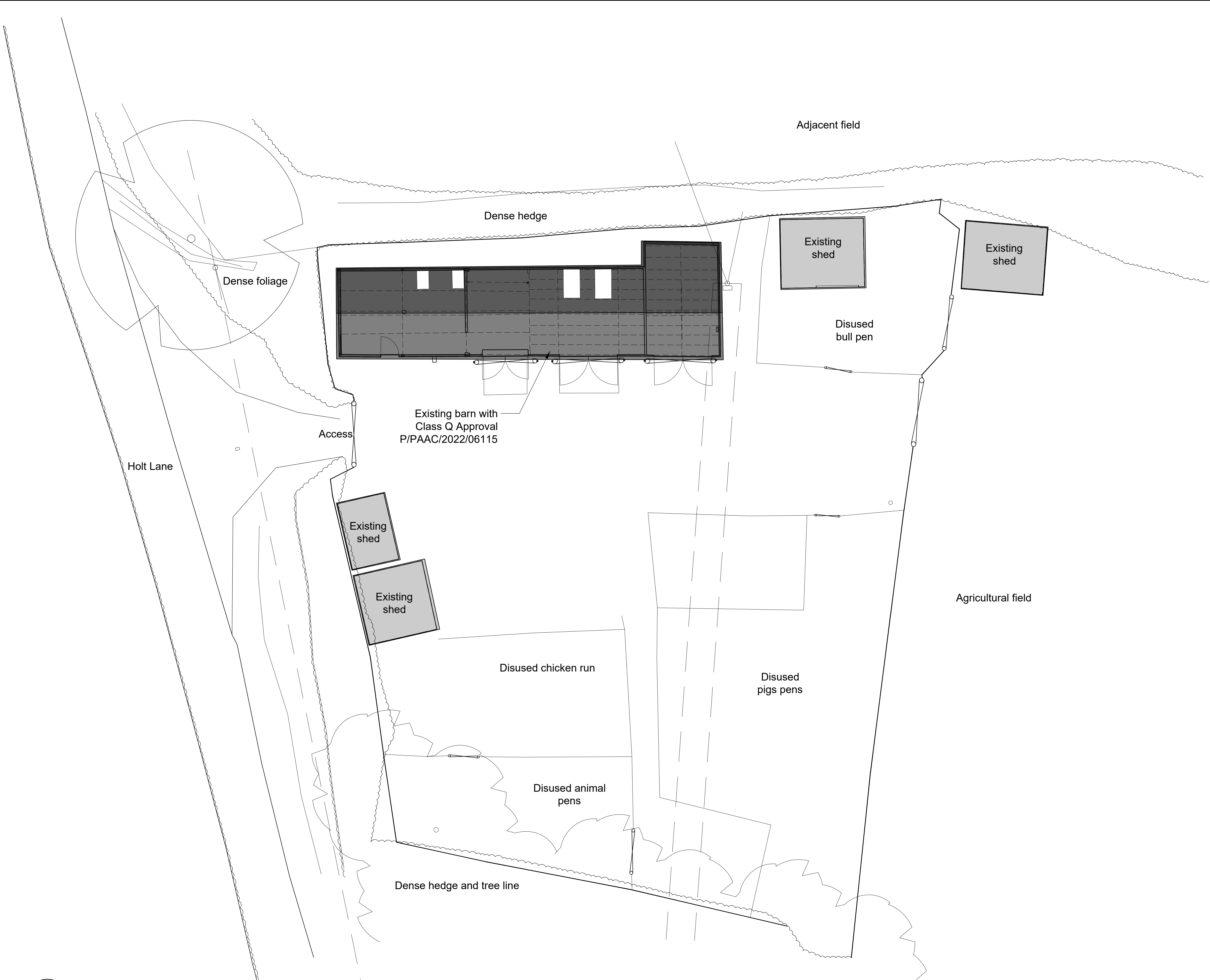

Existing Site Plan showing Roof Plan
Scale 1:100@A1



DESIGNERS RISK ASSESSMENT-
HEALTH AND SAFETY
THE CONSTRUCTION (DESIGN AND MANAGEMENT) REGULATIONS 2015
For significant hazards specific to the project please refer to
Drawing CDM01 where appropriate

NOTES:-

NOTES FEASIBILITY SKETCHES
Please note: this sketch is based on limited information and subject to the following list of consultants, reports and searches that should be instructed/consulted as soon as possible to confirm the validity of this feasibility (this list is not exhaustive):
1) Site Ownership
2) topographical survey
3) tree constraints plan by qualified consultant
4) local and utility searches
5) local policies and constraints; e.g flood zones, SSSI's, conservation areas etc.
6) Ecology
7) Ground Contamination

REV.	REVISION DETAILS	BY	CKD	DATE

WDA

westerndesignarchitects.com

Western Design Architects
12 The Granary, Hinton Business Park, Tanqueray Hinton, Dorset, DT11 8JF
T:01258 830675 E:info@westerndesign.co.uk

CLIENT		Wanda and Paul Stainer	
PROJECT		The Cow Shed, Holt Lane	
DRAWING TITLE			
Existing Site Plan showing Roof Plan			
DRAWN BY	CHECKED BY	DATE	
EG	PE	15.12.2022	
SCALE	JOB NO.		
1:100@A1	2223017		
DRAWING NO.		REVISION	
102		-	
PLANNING			
THIS DRAWING IS COPYRIGHT © Western Design Ltd 2023			