

- 5 If there is not enough parking, please do not make us pay to park. Keep it as clear as possible for everyone to park
- 6 Increased use will undoubtedly cause problems with the already limited parking spaces
- 7 One question - it's great encouraging lots more people to use the rec, but where are they all going to park? The existing car parking facilities are tiny, the additional traffic parking along North Trade Road, into Wellington Gardens and on the private land at Chain Lane is not only taking up residents' parking but also creating traffic problems, particularly for emergency services, and it can be horrendous at school times, with the parking on the pavements from inconsiderate drivers also dangerous to pedestrians. It's like this now - in lockdown! - so what it will be like when the football season is back on, the outdoor gym and playgrounds are being used, there's parties and meetings in the clubroom, lots and lots of cyclists on the bike bumps.... serious thought needs to be given to improving parking arrangements - somewhere - and very soon. Perhaps extending the car park into the area under the trees where nobody goes or using the land where the wooden climbing area that isn't much used is sited?
- 8 Parking could be an issue, as car park already very busy at peak times, possible impact on neighbouring roads
- 9 Parking may be a problem for evening clubs
- 10 Will parking be an issue if the rec becomes more popular? Has thought been given to extending car park so local roads are not affected?

Ecology/Environment

- 1 I love to be outside in nature and not take a car to get there but there is no areas in winter that don't involve getting covered in mud or taking a car out. The Blackfriars development is going to take away more green space and not give us anything other than more pollution and traffic there should be better consideration of developing this side of Battle to support Marley Lane and Battle Hill residents who can get space in nature without having to use a car, you can't get to Battle Great Woods without either a car or having to navigate deep mud, it would be good if paths could be extended people being able to walk in the woods all year round not just a couple of months in the summer.
- 2 I would like to see more dog free areas
- 3 We hope that a good tree line & evergreen shrubs, will be planted between the Rec & North Trade Road to absorb pollution & noise

Funding/Costs

- 1 No barriers other than the time it might take to raise funds
- 2 The glaring gap in this questionnaire is the absence of detail about costs (both capital & revenue) & information about other options, including doing nothing, which may have been considered and why they were dismissed. Human nature is always to want to improvements to our way of life & it is therefore tempting to tick Yes to anything which might provide such changes but what might be nice to do must be considered against cost which this questionnaire alone cannot achieve
- 3 The money could be far better spent elsewhere

Inclusion

- 1 It is important to make the park inclusive for all, so those with additional needs can also enjoy the facilities...from toilets, ramps, low swings, visuals, sensory sound area, (the sensory garden/ planting is splendid) through to the playing facilities. The bike skills track, which is amazing and is being highly used as you know, I think we just really need to look into how we can prevent accidents with the tiny ones who aren't quite skilled enough to be on there yet. My son has enhanced lots of his social skills that being at school couldn't have necessarily provided to that level...the track has been a blessing to the community during lockdown, so thank you for that
- 2 Must be disability friendly. Cannot use unless easy access for wheelchair or small ride-on

Pavilion as a whole

- 1 I am concerned this would become a white elephant if not managed properly, lots of different people using and accessing the space will need careful monitoring and the cafe would need to be well run and maintained to be of interest. I think there needs to be a clear focus of what the space is used for which is why I am not in favour of it being used for a wide mix of community activities
- 2 I can see no reason why I would use these facilities. I am concerned the continuing development of the recreation ground is creating more traffic/parking/noise problems which aren't being addressed. Would like to see more shrubs, flower beds and wild flower areas planted in the recreation ground to provide some colour, and commission sculpture/ statues for artistic interest
- 3 I wonder if the storage facility designed under the new pavilion would be extensive enough, or secure enough, if it is to be used for access to bikes, football equipment, tennis equipment plus any other organisations that will want to use the pavilion in the future
- 4 I would love to have some fitness classes added to the pavilion timetable (body pump/spin/step classes/yoga etc) and in the spring/summer months having yoga on the green (pay as you go option). It would be a great way to meet like-minded people in the area and to catch up with friends. I do not see any barriers to myself or my husband using the facilities
- 5 If there is more than 1 football match +/- tennis games occurring, is 2 changing rooms enough for 2/3+ sports teams? Would an additional changing room be prudent? In addition - I do not believe adding a cafe would be helpful as it may drain council/community resources at a time when monies are tight but will also draw trade away from the great independent coffee shops and high street we have in battle (which is not that far away from the Rec)
- 6 Local Recreation Hall is well needed
- 7 No benefits for me. Wrong end of town anyway. But facility would be useful for sports organisations using Rec & it is to them that Town should look for funding. Clear financial plan essential
- 8 Re barriers, hire prices for changing room, meeting rooms & refreshment area (including the prices for the refreshments themselves need to be affordable to all - eg via tiered hire prices for youth clubs & charities etc
- 9 Such a shame the current building is so empty. Many teenagers hang around the Rec. Maybe a youth club may be a good idea, 1 night a week

- 10 The plans look ambitious but I worry about the running costs and more importantly the cleaning costs. Footballers leave changing rooms in a muddy-messy condition, not because they mean to but because they often get very muddy during a match. Much hot water is required for showers and shower areas and wet floors need cleaning and mopping after use. Also adequate ventilation to stop damp. Cannot see any outside ventilation for shower area and WC so guess extractor fans will need to run. Is the hire charge for the use of the football pitch going to be increased to cover all the extra cleaning costs? For a number of years we ran youth football teams so know how dirty these areas can become. Footballers will go to the changing room in their boots no matter how many signs you install! Large clumps of mud are inevitable! There would in my opinion need a full time cleaner at the premises in order to maintain hygiene standards, there are quite a lot of toilet areas!
- 11 Toilet facilities need to be provided for visitors to the Rec and the café, not just for teams playing sport. Offer the franchise to run the café to one of the existing coffee/tea establishments in Battle
- 12 Use the Guide Hall more. We have plenty of cafes in the High Street already
- 13 Will the new pavilion compete with the Memorial Hall for e.g. for the meetings of local organisations? How far have you done research into demand for space for clubs to meet? The Chess club has about 4 people in it. I can't tell from the plan above how big a club room would be
- 14 Youth Club

Personal/Individual

- 1 Age
- 2 Our ill health
- 3 Female safety needs to be considered. Way to entrance must be well-lit during dark evenings
- 4 Has anyone noticed the state of the roads & the extra construction-related lorry damage
- 5 Include a water fountain to reduce single use plastics. Accessible socket for charging e bikes
- 6 Cost
- 7 Looks like the cycle facility needs extending already as it is so popular with all ages
- 8 None
- 9 The only barrier would be the muddy field between where I live and the building. If the but behind the playgroup could be tarmacked it would improve my journey no end!!
- 10 The Rec is an open space. I would use it more if it had not been gradually reduced as an open space over time
- 11 This should be available online & there is no opportunity for more than one resident per household to respond

Vandalism

- 1 I worry about vandalism, either with the pavilion or with the lovely shrubs & trees being planted.
A very small minority could ruin such a good work already in place
- 2 Needs good visible security, CCTV to prevent criminal activity/vandalism by a minority Needs maintenance and to be kept clean and tidy

Annex D:

Other comments

Annex D lists the specific comments which respondents additionally made under Questions 1, 2 & 3, and should be noted alongside the respondent results shown for these questions within the report.

Question 1-Are you in favour of the proposed pavilion for use by local sports clubs for changing facilities?

1 Yes - but I am only in favour of the pavilion provided BTC is only expected to contribute to capital cost & responsibility for maintenance, repair & all running costs is clearly assigned to users.

2 Blank. BTC's policy to upgrade the Rec to a public park with facilities from which all sections of the community can benefit, is to be applauded. The changes made over the last couple of years will hopefully continue to be taken advantage of by all potential users on a regular basis, thus justifying the financial contribution made by all residents through their Council Tax. The same consideration should be applied to the pavilion project. Although the questionnaire suggests that the capital cost of the project will be "largely funded by external bodies", some of the cost will inevitably have to be met from Council Tax. Indeed if, as appears to be the case, planning permission has already been obtained before residents' views have been sought, some cost to the taxpayer has already been incurred. There will also be unquantified ongoing running costs which will presumably have to be met by BTC. The most significant questions on which residents are being asked to comment cannot therefore simply be answered yes or no. The long term future of small sports clubs cannot be guaranteed as evidenced by periodic reports in the local press highlighting this fact. A successful & ambitious club depends on current support & enthusiasm of those involved, but personnel & loyalty change along with club fortunes. Encouraging sports clubs should clearly be BTC policy but the associated level of investment to support the policy needs to be carefully considered with those who might benefit most taking the greatest risk both now & in the future. In the case of the pavilion, if the primary need for improvement stems from the requirement of sports clubs, they should pay for it, not the residents. More clarity is required about the level of funding from the Football Foundation & others & not just a comment that such sources will provide the majority of the funding.

Question 2-Are you in favour of the proposed pavilion café for refreshments & for meeting up with friends/socialising to make new friends?

1 No. Maybe nice to do but, again, to what extent will residents as a whole benefit. & as a mini-business, will it require public subsidy by the taxpayer? These questions need to be carefully considered & the assumptions behind the answers publicised. If BTC is prepared to subsidise ongoing losses for the general good this needs to be made clear to residents so that they can make an informed opinion before a final decision is taken. The possible impact on already struggling businesses in the Town is also a relevant factor. Have they been consulted, perhaps through the Chamber of Commerce? It is also clearly prejudicial to state, in promoting the pavilion project, that "the cafe is a much requested facility"? What is the evidence for "much requested"? Surely the

whole purpose of the questionnaire is to establish the level of such interest, not to influence people to endorse an existing claim & therefore pre-empt the outcome?

2 No. Battle already has numerous cafes

3 No. Enough cafes in Town

Question 3-Are you in favour of the proposed pavilion clubroom for regular meetings by local organisations & for activities such as Chess club/other?

1 No. Battle Memorial Hall provides this facility.

2 No. No clear evidence of need. There are already plenty of such potential meeting places in Town to which BTC is proposing to add through its own Almonry project. Is this question based on demand, or simply to find justification for the project?

3 No. There are already places for meetings of local organisations -places that need the rent.

Note: It is appreciated that some comments recorded under each question's categories, could also have been as relevant to others, however, a judgement has been made on the best fit, and they have only been recorded once throughout the report.

End

Residents' questionnaire about a new changing Pavilion, including meeting room and café at Battle Recreation Ground

The Battle Recreation Ground (the Rec) is a focal point for residents for exercise, leisure and simply enjoying nature. Battle Town Council, in partnership with local organisations, is continually upgrading the leisure offer on site for residents. Recent developments include a health pathway and cycle skills area. The Council now wishes to move on to the next phase, with a new changing Pavilion, including a meeting room for community organisations, and a community café, **funded largely by external bodies**. It wants to **consult local residents and local community organisations**, and it would be really helpful to have your views on this proposed development by completing the questionnaire below:

Please tick yes/no or add comments where optional

- 1) Are you in favour of the proposed Pavilion for use by local sports clubs for changing facilities?
Yes No
- 2) Are you in favour of the proposed Pavilion Café, for refreshments and for meeting up with friends/socialising to make new friends?
Yes No
- 3) Are you in favour of the proposed Pavilion Clubroom for regular meetings by local organisations and for activities such as Chess club/ other?
Yes No
- 4) Do you feel the range of proposed facilities at the Pavilion would increase your usage of the Battle Recreation site?
Yes No
- 5) Do you feel the proposed facilities would improve your physical and mental wellbeing, skills, or promote better community cohesion?
Yes No
If yes, how? _____
- 6) How will you personally use the new facilities?

- 7) Any ideas or suggestions from you? i.e. What are the benefits for you personally of using the facilities/Do you foresee any barriers to you using the facilities?

Please complete the information below to help us with the survey. Tick one per question. Thank you.

Are you a local resident: Yes No **Gender:** Male Female Other

Age group: U18 18-24 25-34 35-44 45-54 55-64 65 and over

Do you consider yourself a disabled person: Yes No

Ethnicity: White Asian or Asian British Black or Black British Other ethnicity (inc Chinese)

Please return completed questionnaires the Town Council office at The Almonry, High Street, Battle TN33 0EA, email to: DTC-TDO@battletowncouncil.gov.uk or fill in the online questionnaire: www.battletowncouncil.gov.uk by **11th April 2021**.

Battle Town Council

The Almonry, High Street, Battle, TN33 0EA

01424 772210 enquiries@battletowncouncil.gov.uk

 /BattleTownCouncil

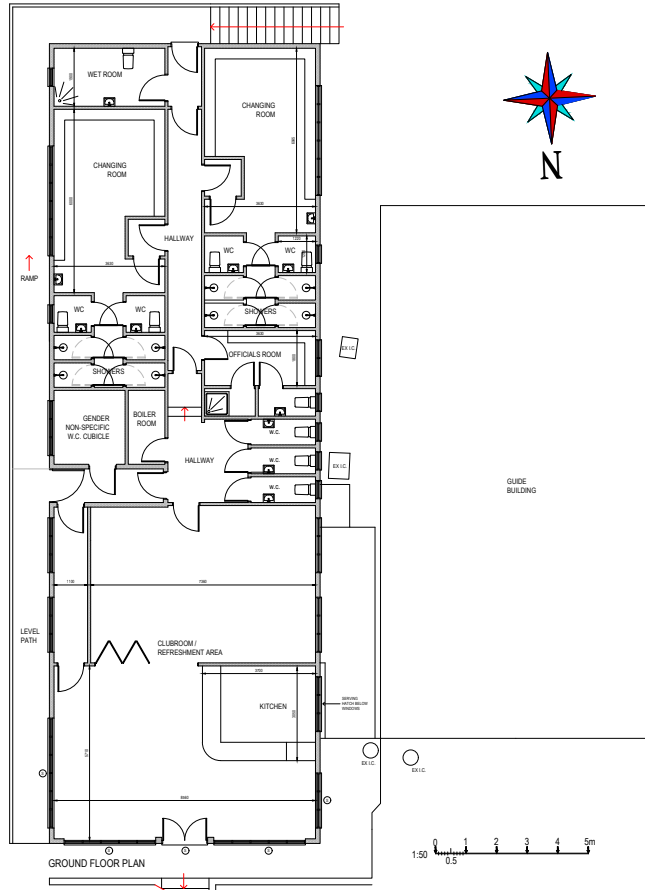
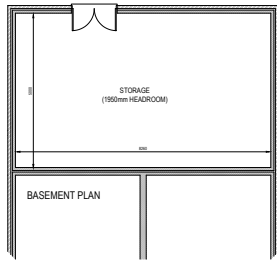

GENERAL NOTES

1. ALL DIMENSIONS TO BE TAKEN UNLESS OTHERWISE STATED TO THE CONTRARY.

2. ALL DIMENSIONS TO BE TAKEN UNLESS OTHERWISE STATED TO THE CONTRARY.

3. ALL DIMENSIONS TO BE TAKEN UNLESS OTHERWISE STATED TO THE CONTRARY.

4. ALL DIMENSIONS TO BE TAKEN UNLESS OTHERWISE STATED TO THE CONTRARY.

5. ALL DIMENSIONS TO BE TAKEN UNLESS OTHERWISE STATED TO THE CONTRARY.

6. ALL DIMENSIONS TO BE TAKEN UNLESS OTHERWISE STATED TO THE CONTRARY.

7. ALL DIMENSIONS TO BE TAKEN UNLESS OTHERWISE STATED TO THE CONTRARY.

8. ALL DIMENSIONS TO BE TAKEN UNLESS OTHERWISE STATED TO THE CONTRARY.

9. ALL DIMENSIONS TO BE TAKEN UNLESS OTHERWISE STATED TO THE CONTRARY.

10. ALL DIMENSIONS TO BE TAKEN UNLESS OTHERWISE STATED TO THE CONTRARY.

KEY

ELECTRICALLY OPERATED SECURITY SHUTTER (S)

PumpHouse
DESIGNS
Architectural & Interior
Design Consultants

Pump House Yard
The Dales
Culterstone
Sheff Sumer
TN32 5QA
01293 810000
www.pumphousedesigns.co.uk

NO.	REVISION	DATE

**BATTLE RECREATION GROUND
NORTH TRADE ROAD
BATTLE
for Battle Town Council**

PROPOSED FLOOR PLAN - FINISH

DRAWN BY - JPL

DATE - SEPTEMBER 2019

SCALE - 1:50 @ A1

DRAWING No. 6744 / 2019 / 1 / A

Annex: F Hyperlink and copies for related consultation reports

1 Battle Health Pathway Public Consultation Report - 2016 <http://www.nickwates.com/wp-content/uploads/2016/04/ReportApril2016Lo.pdf>

2 For copies of the following consultation exercises please contact Battle Town Council on 01424 772210.

* Facilities for Teenagers in the Recreation Ground in North Trade Road Consultation- 2017;

* Pavilion and cafe consultations overview and questionnaire document - 2019;