

BOUGHTON MALHERBE PARISH COUNCIL  
PROPOSED GRAFTY GREEN TRAFFIC CALMING THROUGH VILLAGE  
MARCH 2020

1:1,000 @ A1

KEY & NOTES

- Roadside pavement
- Road in details 1,2 & 4
- Road verge
- Red tarmac. Existing surfaces to be stripped to 40cm depth & replaced with SMA. High friction red tarmac - high tension version. Markings as per diagrams 1004 & 1012-1 of TSRDG 2016. (30MPH roundels not shown)
- Existing 30MPH back to back signs
- All roundels on red tarmac as per 1065 of TSRDG 2016
- Road narrowing feature with flush granite setts & marking to TSRGD2016, DIAGRAM 1004

DO NOT SCALE OFF THIS DRAWING

ROAD WHITE LINING DOWN CENTRE OF ROAD THROUGHOUT LENGTH OF VILLAGE TO BE PROVIDED SUBJECT TO KCC AGREEMENT.

THIS DRAWING IS FOR APPROVAL PURPOSES ONLY. FINAL DETAILS & DIMENSIONS TO BE DECIDED IN CONJUNCTION WITH KCC ROADS DEPARTMENT

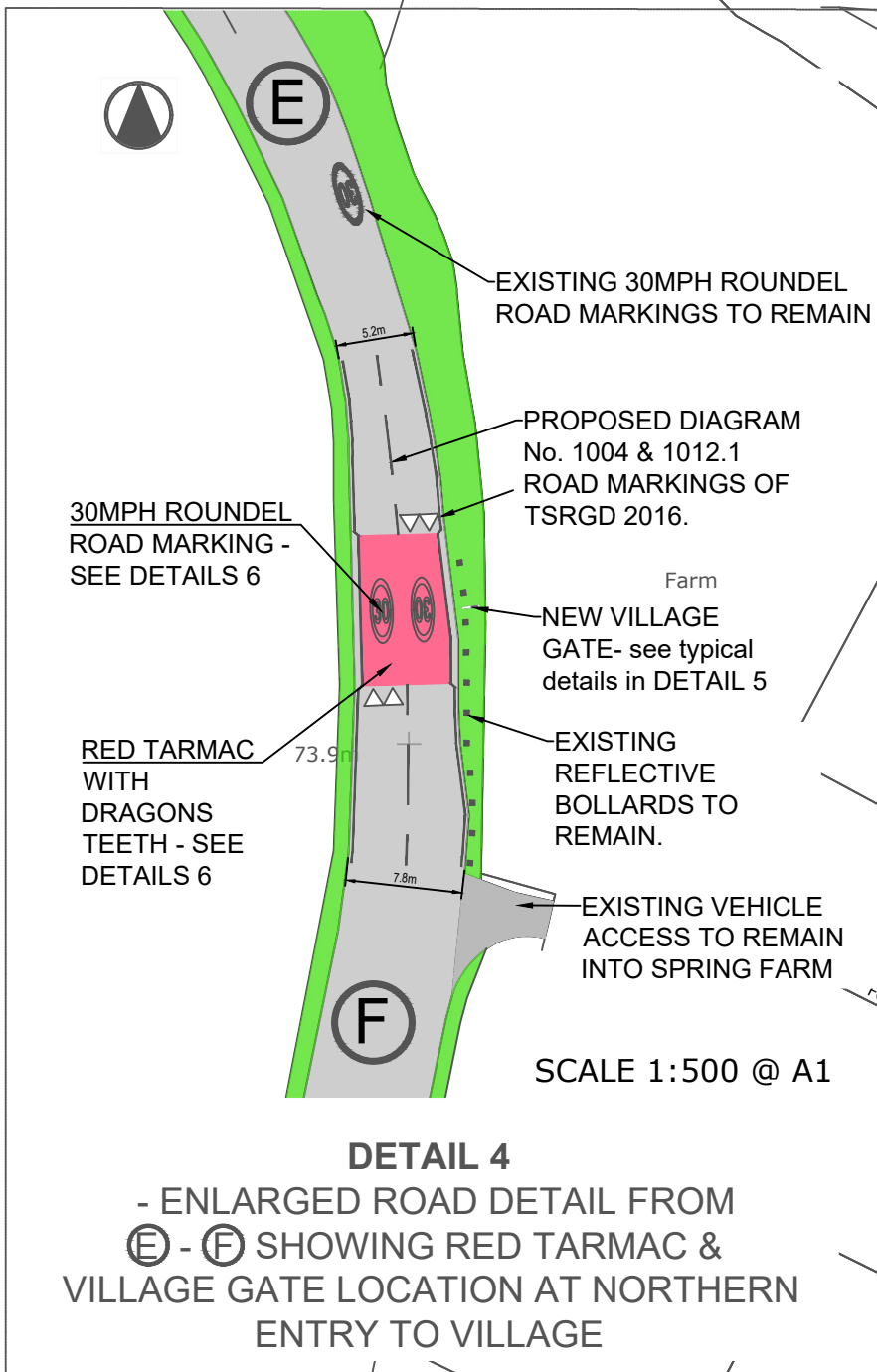

VILLAGE GATE VIEWED LEAVING VILLAGE AT SOUTH END, SIGN READS:-



VILLAGE GATE VIEWED ENTERING VILLAGE AT NORTH & SOUTH END, SIGN READS:-

THANK YOU  
FOR DRIVING  
CAREFULLY

WELCOME TO  
GRAFTY GREEN  
PLEASE DRIVE CAREFULLY

NOTE: GATE VIEWED LEAVING VILLAGE AT NORTH END WILL HAVE 30MPH ROUND, OTHERWISE AS SHOWN

DETAIL 5  
TYPICAL DETAILS OF VILLAGE GATES AT NORTH & SOUTH ENDS OF GRAFTY GREEN VILLAGE

SOUTH FACING VIEW



NOTE: 30MPH SIGN ALSO ON NORTH FACING SIDE OF POLE

DETAIL 3  
NEW GLASDON SIGN ON POLE CLEAR OF ACCESS TO FIELD GATE N.T.S

REPLACE EXISTING 30MPH ROUND WITH RED TARMAC WITH WHITE DRAGONS TEETH AT EACH END, TO CREATE FAKE SPEED BUMPS. 30MPH ROUND ON WEST SIDE OF ROAD ONLY.

EXISTING 30MPH SIGN TO BE MOVED TO ORIGINAL LOCATION OPPOSITE VILLAGE GATE

DRAGONS TEETH EACH SIDE OF CARRIAGEWAY LEADING UP TO RED TARMAC FEATURE, AS DETAIL 7

NEW ROAD NARROWING FEATURES, SIMILAR TO THOSE SHOWN IN DETAIL 1

REPLACE EXISTING ROUNDLS WITH RED TARMAC FEATURE & DRAGONS TEETH AS DETAIL 6

30MPH SIGN TO BE REMOVED  
EXISTING 30MPH ROUND ROAD MARKINGS TO REMAIN

FIELD GATE

EXISTING VILLAGE ENTRY SIGN TO BE REPLACED WITH NEW VILLAGE GATE - see typical details in DETAIL 5



DETAIL 6  
AN EXAMPLE OF FAKE SPEED BUMPS ONLY ONE 30MPH APPLIES AT SOUTH ENTRY TO VILLAGE GOING NORTH



DETAIL 7  
AN EXAMPLE OF DRAGONS TEETH LEADING TO FAKE SPEED BUMPS AT ENTRY TO VILLAGE AT SOUTH END

0 10 20 30 40 50 100m

DRG No. BMTC-001

TO LENHAM

RED TARMAC FEATURE & DRAGONS TEETH AS DETAIL 6

NEW VILLAGE GATE- see typical details in DETAIL 5



30MPH ROUND ROAD MARKING AS DETAIL 6

REMOVE GRAFTY GREEN SIGN FROM THIS POLE

BLUE POLICE SPEED CHECK AREA SIGN

RED TARMAC FEATURE WITH 30MPH ROUNDLS & DRAGONS TEETH AS DETAIL 6

NEW ROAD NARROWING FEATURES, SIMILAR TO THOSE SHOWN IN DETAIL 1

NEW ROAD NARROWING FEATURES, SIMILAR TO THOSE SHOWN IN DETAIL 1

30MPH ROUND ROAD MARKING

REPLACE EXISTING ROUNDLS WITH RED TARMAC FEATURE & DRAGONS TEETH AS DETAIL 6

30MPH SIGN TO BE REMOVED  
EXISTING 30MPH ROUND ROAD MARKINGS TO REMAIN

FIELD GATE

NEW ROAD NARROWING FEATURES, SIMILAR TO THOSE SHOWN IN DETAIL 1

EXISTING ILLUMINATED 30MPH FLASHING SIGN

HILLSIDE

TUDOR COTTAGE

WRENS NEST

TO HEADCORN

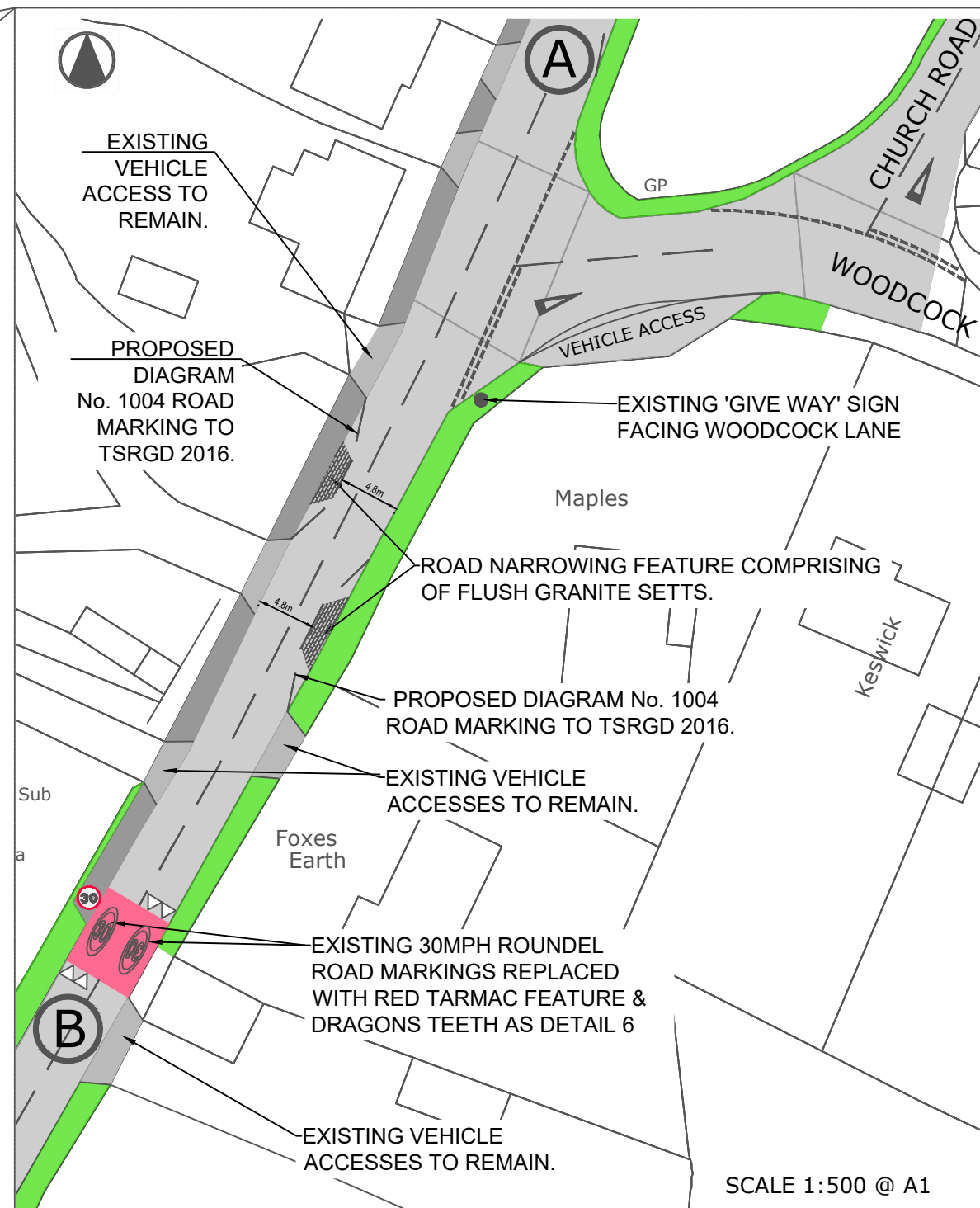

DETAIL 1  
- ENLARGED ROAD DETAIL FROM A - B  
SHOWING ROAD NARROWING FLUSH GRANITE SETT FEATURES

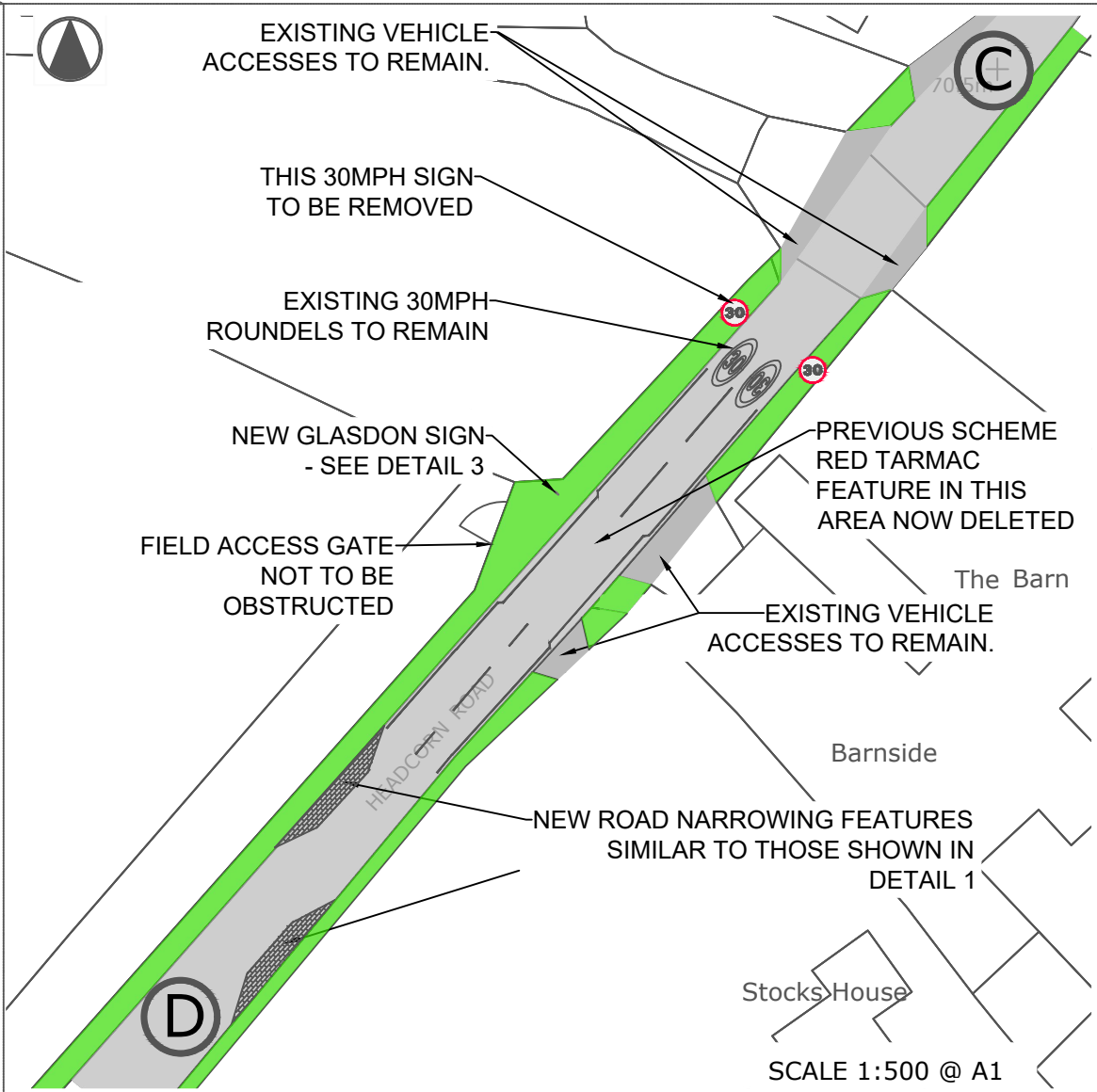

DETAIL 2  
- ENLARGED ROAD DETAIL FROM C - D