

Wiltshire Council Legal Unit
County Hall,
Trowbridge,
Wiltshire
BA14 8JN
DX 116892 Trowbridge 3

Mrs S. Harry
Donhead St Andrew Parish Clerk
'Truffles', Pigtrough Lane
Donhead St Andrew
SHAFTESBURY
SP7 9ES

Our ref: 115549

18 December 2017

Dear Mrs. Harry,

Re: Proposed application under section 116, Highways Act 1980
Highway at The Castle, Brookwater, Donhead St Andrew

I refer to the two sections of highway shown cross-hatched on the enclosed plan and advise that Wiltshire Council has received a request to apply to the magistrates' court to extinguish or stop up the highway rights running over these areas. The request has come from Mr and Mrs Hay of The Castle and the Area Highway Engineer is satisfied, in principle, that the areas concerned are unnecessary for public use or any other highway-related purpose. This is the statutory criterion which must be applied to such requests.

I would be grateful, if possible, if this request could be discussed at the parish council meeting on 12 January 2018. If you have any queries regarding the proposal, please contact me. Otherwise, please complete and return the enclosed form to let me know whether the parish council consents to the proposed application. If you do not consent, please let me have a full statement of your reasons. I will similarly consult Councillor Tony Deane, as Wiltshire Council member for the area.

If you consent, I will prepare a report for Cllr Bridget Wayman, Wiltshire Council's Cabinet Member for Highways, Transport and Waste. She will then decide whether the Council should proceed with the proposed application. I will of course keep you informed.

Yours sincerely,



Kevin Gale
Chartered Legal Executive

Direct Line: 01225 718023
Fax Number: 01225 713998
Email: kevin.gale@wiltshire.gov.uk

Enc.

WILTSHIRE COUNCIL
HIGHWAYS ACT 1980
SECTION 116 APPLICATION

Highway at The Castle, Brookwater, Donhead St Andrew

Donhead St Andrew Parish Council hereby consents / does not consent* to Wiltshire Council making an application to the Magistrates for an Order under Section 116 of the **Highways Act 1980** providing for the stopping-up of two areas of highway on the ground that they are unnecessary for public use. The areas of highway concerned are shown cross-hatched on the plan on the reverse of this form.

Signed

Please print name.....

Post held.....

Date

Please return this form to:-

Solicitor to the Council
Wiltshire Council (Ref: **KG/115549**),
County Hall,
Trowbridge,
Wiltshire BA14 8JN

* Please delete as applicable

**Proposed application to stop up highway at The Castle, Brookwater,
Donhead St Andrew, SP7 9LG.**

Date: 27th November 2017.

Centre co ordinates: 391919 123437.

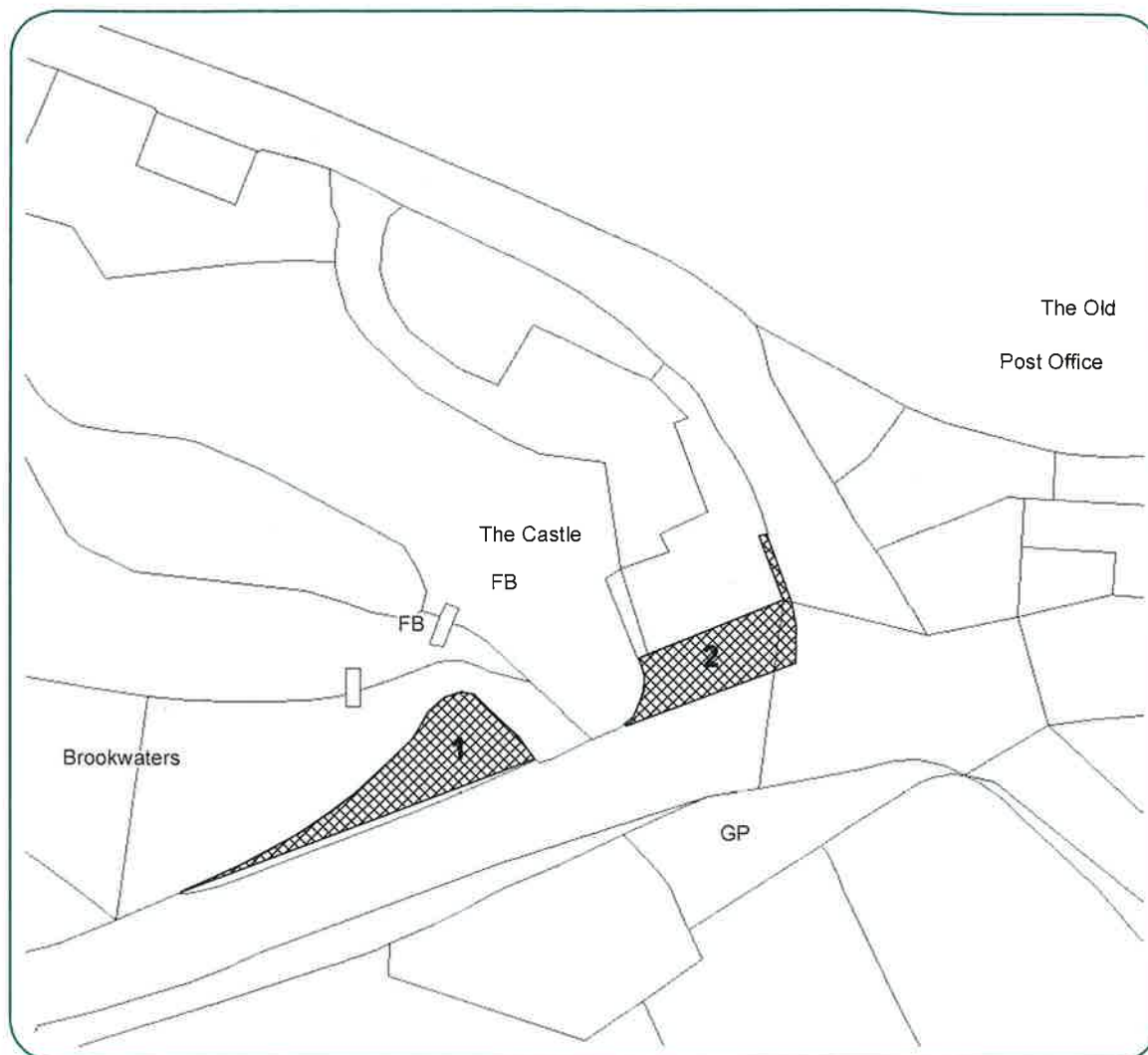

Section 116, Highways Act 1980

Areas of highway proposed to be stopped up are shown edged and cross hatched black.
Parcel 1: approximately 22.4 metres at the road frontage and 24.5 at the rear, tapering
from 0 to 9.7 metres from west to east.

Parcel 2: approximately 16.6 metres at the road frontage by 5.4 metres in depth at the
western end and 13.8 metres at the eastern end.

