

St Mary The Virgin

Great Milton

CHURCH DEVELOPMENT PROJECT

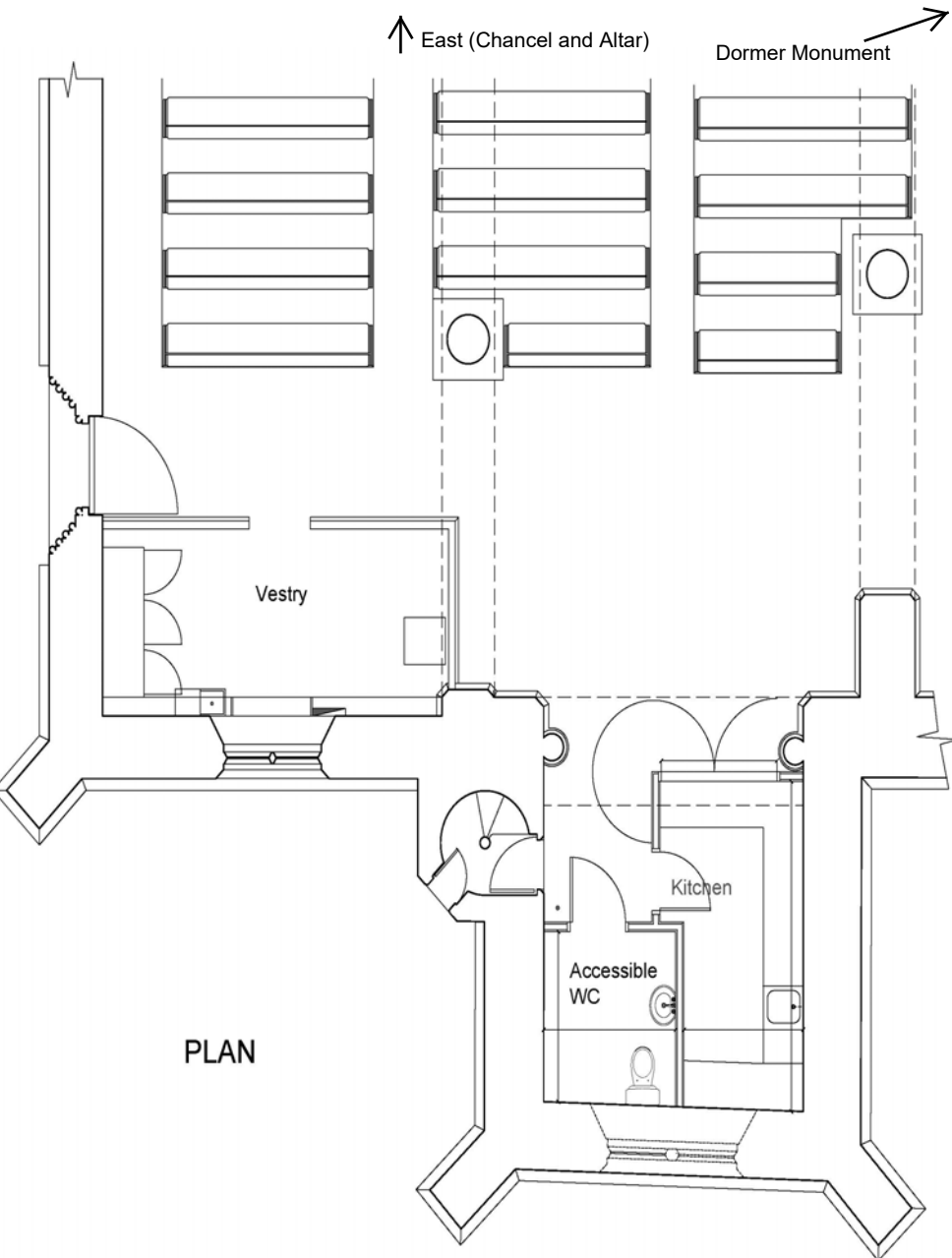
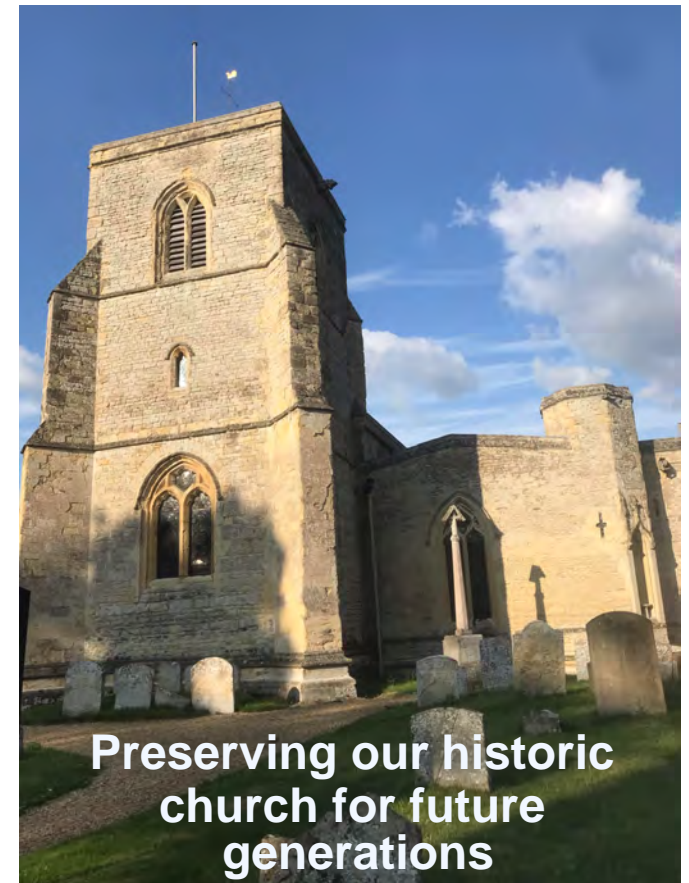

CONTACTS:

Clare Blakeway-Phillips
Trudy Timbs

clareblakeway@gmail.com
trudytimbs@yahoo.co.uk

January 2020

FOR MORE INFORMATION VISIT WWW.GREAT-MILTON.CO.UK



“St Mary’s church is at the heart of our community and stands as a symbol of our shared history. This bold and exciting project will make our church a more versatile space for worship and community use alike.”

Simon Cronk, Rector

What is the Church Development Project?

The urgent priority is to restore and repair the medieval church tower stonework to make it safe and relevant for generations to come. The historically-significant Dormer Monument will be returned to its original setting and, in its place, a much-needed kitchen and WC will be installed. By removing some pews, immediately in front of the tower, an adjacent flexible communal space will be created.

Why is this project so important?

St Mary’s church dates back to the 11th century and restoration is essential if it is to remain open. The project will be an opportunity to stimulate interest in, and knowledge of, the church’s place in our village, allowing us to connect with the wider community and welcome more people into this wonderful building.

How are we planning to achieve it?

Chartered Surveyors and Historic Buildings Consultants, Arnold Bartosch Ltd, have assessed the work that needs to be done, internally and externally, to make the tower safe and sound for the long term, and have also drawn up plans for a kitchen and WC in the tower. A volunteer group will bring together those with specific skills who can contribute to making a great success of the project.

How will we keep you updated?

Updates through the Great Milton Bulletin, the village website, social media and community meetings.

A programme of activities will take place over the life of the project, including an exhibition with the History Society.

The restoration will be recorded in pictures and short film recording commentary from the various craftsmen and local people giving historical context.

What is the proposed timeline?

April 2019 onwards: Local fundraising
2019 / 20: Awards for All Lottery funding application process
2020 / 21: Heritage Lottery Fund (Stage 1) application
2021 / 22: Heritage Lottery Fund (Stage 2) application
2023 / 24: Building work on the church

What will we achieve?

The village will be better informed about its history and have a building better able to continue to stand for future generations and support its community. A more welcoming atmosphere can be achieved with modern facilities and space to offer refreshments and opportunities for people to meet, connect and share experiences and thoughts. Activities and services can be extended, for instance, with Sunday School and Tea Services as identified in our Village Plan. The Dormer Monument will be moved and conserved for the future to be admired by locals and by artists, historians and visitors alike.

How much will it all cost?

The current estimate for the whole project is just over £400,000.