

Notice of survey work on A53, Bent Lane and A525

March 2022 | www.hs2.org.uk

High Speed Two (HS2) is the new high speed railway for Britain. Working on behalf of HS2 Ltd, Kier is carrying out surveys and investigating ground conditions along the Phase 2a route

What we are doing

We will be carrying out ground penetrating surveys to help us identify the location of buried utility services, such as gas, electric or water. These surveys are non-intrusive, we will use a machine that transmits an electromagnetic pulse into the ground. These pulses reflect off features in the ground, allowing us to collect data and to understand the depth of the buried utility services.

Along with ground penetrating surveys, we will carry out several other surveys. For the safety of both our workforce and motorists, we need to install a road closure on Bent Lane during the day. We will also need overnight temporary traffic lights on the A53 between Whitmore and Baldwin's Gate. An overnight closure is also required on the A525 between Aston Lane and Manor Road.

When the work will take place

These works will take place between **Thursday 7 April to Thursday 14 April 2022**. Please note that all our planned roadworks may be subject to change due to weather conditions or unforeseen circumstances.

Covid-19

We are working in line with Government and Public Health England (PHE) advice on working safely during the pandemic. For all events and engagement, we will carry out a risk assessment and put in place control measures to manage the risk of Covid-19 to the public and our staff. If you have any questions about this, please contact our Helpdesk to find out more. The health and safety of our workforce and the communities we affect is our key priority.

If you have a question about HS2 or our works, please contact our HS2 Helpdesk team on 08081 434 434 or email hs2enquiries@hs2.org.uk

Notification



Duration of works

Bent Lane closure
Thursday 7 April to
Thursday 14 April
(excluding weekends)

A53 temporary traffic
lights Monday 11 April
to Thursday 14 April
overnight

A525 road closure
Monday 11 April to
Thursday 14 April
overnight

What to expect

Temporary traffic lights
on the **A53**

Road closure of **Bent**
Lane

Road closure on **A525**

Some delays

Low levels of noise

What we will do

Maintain access to
businesses and
properties within the
closure

Notify you in advance
of any changes

Notice of survey work on A53, Bent Lane and A525

Notification



www.hs2.org.uk

How this will affect your journey

From **Thursday 7 April** to **Thursday 14 April** from **9am** to **4pm** we need to close Bent Lane. During the closures, we will put a signed diversion route in place, please allow extra time when planning your journey.

From **Monday 11 April** to **Thursday 14 April**, we will need to install temporary traffic lights overnight on the A53 between Whitmore and Baldwin's Gate **8pm** and **5am**. Please allow for a small delay when planning your journey.

From **Monday 11 April** to **Thursday 14 April**, we will need to install an overnight closure on the A525 between Aston Lane and Manor Road working between **8pm** and **5am**. During the closures, we will put a signed diversion route in place, please allow extra time when planning your journey.

How we will minimise disruption

We will maintain access to all properties within our traffic management. The nature of the work is non-intrusive and should not affect nearby properties. We will only close the road when we are working, and will put a fully signed diversion route in place.

Where we will be working

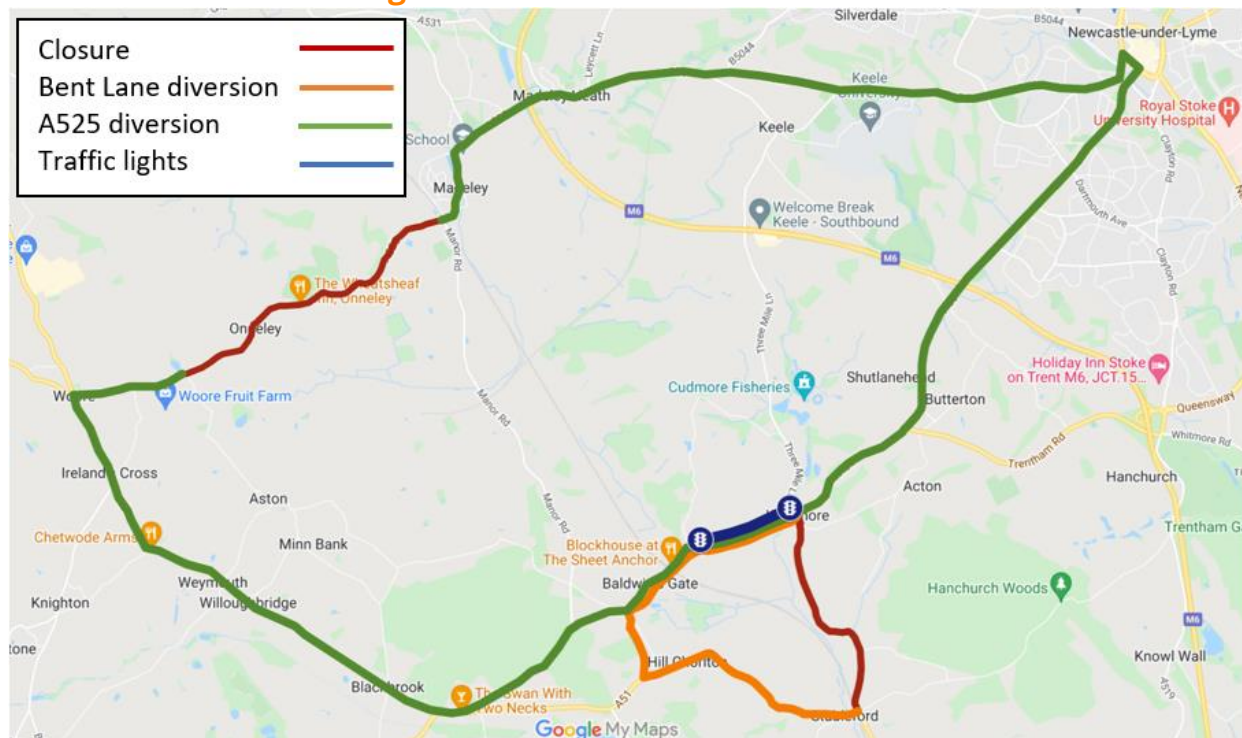

Contact our HS2 Helpdesk team on **08081 434 434**

What else is happening in your area?

www.hs2.org.uk

Contact our HS2 Helpdesk team

Our team is here to listen and respond to your enquiry, complaint or feedback to help us be a good neighbour.

You can contact our Helpdesk team all day, every day of the year on:

Freephone: **08081 434 434**

Minicom: **08081 456 472**

Email: hs2enquiries@hs2.org.uk

Keep up-to-date with your local community website

To find out more about what's happening in your area and receive regular email updates, you can sign up to our local community websites at: www.hs2inyourarea.co.uk.

About our Community and Business Funds

Two funds are now open for applications from local communities and businesses affected by the construction of HS2. They are the Community and Environment Fund (CEF) and the Business and Local Economy Fund (BLEF). £5 million has been allocated to the funds for phase 2a of the railway.

The CEF is designed to give communities the opportunity to share in the benefits of HS2. It is an allocated fund that communities are able to apply for, to help to support local projects that aim to improve their local area.

The BLEF is designed to support local economies that may be disrupted by the construction of HS2. BLEF grants are for local business support organisations and local authorities to help maintain business activity in local communities.

For more information about each of these funds, including how to apply, please visit: <https://www.groundwork.org.uk/hs2funds>



Keeping you informed

We are committed to keeping you informed about work on HS2. This includes ensuring you know what to expect and when to expect it, as well as how we can help you.

The Residents' Commissioner

The independent Residents' Commissioner oversees and monitors our commitments to you.

The commissioner's reports and our responses can be found at www.gov.uk/government/collections/hs2-ltd-residents-commissioner

The Residents' Commissioner makes sure we fulfil the commitments in the HS2 Community Engagement Strategy (<https://bit.ly/3oOA25j>).

The Residents' Commissioner can be contacted on: residentscommissioner@hs2.org.uk

Construction Commissioner

The independent Construction Commissioner regularly meets our Chief Executive Officer to raise any concerns or emerging trends across HS2.

The Construction Commissioner's role has been developed to monitor the way we manage and respond to construction complaints.

The commissioner mediates on disputes about construction, involving individuals and organisations, that we can't resolve. The commissioner advises members of the public about how to make a complaint about construction.

The Construction Commissioner can be contacted on: complaints@hs2-cc.org.uk

Property and compensation

You can find out about HS2 and properties along the route by visiting:

www.gov.uk/government/collections/hs2-property

Find out if you can claim compensation at:

www.gov.uk/claim-compensation-if-affected-by-hs2

Holding us to account

If you are unhappy for any reason you can make a complaint by contacting the HS2 Helpdesk. For more details on our complaints process, please visit:

www.hs2.org.uk/in-your-area/contact-us/how-to-complain/

Contact us

Contact our HS2 Helpdesk team all day, every day of the year on:

 Freephone **08081 434 434**

 Minicom **08081 456 472**

 Email **HS2enquiries@hs2.org.uk**

Write to:

FREEPOST

HS2 Community Engagement

Website **www.hs2.org.uk**

To keep up to date with what is happening in your local area, visit:
www.HS2inyourarea.co.uk

Please contact us if you'd like a free copy of this document in large print, Braille, audio or 'easy read' format. You can also contact us for help and information in a different language.

HS2 Ltd is committed to protecting personal information. If you wish to know more about how we use your personal information please see our Privacy Notice:

<https://www.gov.uk/government/publications/high-speed-two-ltd-privacy-notice>

Reference number: HS2-EW-KIER-Ph2a-Ar-CA05-Surv-25-21/03/2022

High Speed Two (HS2) Limited, registered in England and Wales.

Registered office: Two Snowhill, Snow Hill Queensway, Birmingham B4 6GA.

Company registration number: 06791686. VAT registration number: 888 8512 56.