

Tree Planting Proposals - Update March 2021

1 2020 Hedge update.

Update on the hedges planted in March 2020 by Swaffham Rotary Club.

Swaffham Recreation Ground - 2 sections of hedge were planted at the Recreation Ground adjacent to Haspalls Road and Cley Road.

Oaklands - a 50m length of mixed hedge was planted as part of the 'Pocket Parks' project which renewed the play area.

Both hedges have been checked and are growing well, losses have been low and the plants are well established and have grown well in their first year.

2 Sapling Planting March 2021

The trees which were held over from last year have now been planted by the Works team. They consisted of a mix of Oak, Birch and Mountain Ash. Over 50 trees have been planted:

Swaffham Recreation Ground in 6 groups at locations around the edge of the Rec.

Merryweather in 2 groups near the Watton Road end of the area.

Each sapling is surrounded by a tree guard and stake.

3 Tree Council Grant March 2021

A grant of £1045 has been awarded by the Tree Council as part of their Branching Out Fund. The grant is specifically aimed at projects which involve young people, ideally it would be completed this planting season but due to Covid planting has been postponed until the winter of 21/22 so that the youth groups can be involved.

The grant can be claimed after the work has been completed. The Tree Council are quite strict and insist that the work must be as specified on the application.

The aim will be to carry out the planting during 'National Tree Week' between 27 November and 5 December 2021. The trees at Campingland will be planted in association with the 'Teenie Icení Nursery' and at Swaffham Recreation Ground, Merryweather and Swaffham Cemetery with the Swaffham Guides.

The project will fund:

Swaffham Recreation Ground

- Planting of 3 Black Walnut trees to fill gaps in the existing tree avenues. Black Walnut has been used rather than Horse Chestnut as the latter have major problems with disease and die-back so the Black Walnut will help to future-proof the planting. It is a similar type of tree and should compliment the existing.
- Removal of 3x old tree stumps to enable this planting to take place.

Swaffham Cemetery

- Planting of 8 Mountain Ash

Campingland

- Planting of 8 Whitebeam alongside the road.

Merryweather

- Planting of 6 new Norfolk Apple varieties.

Along with bark mulch, biodegradable tree guards and mycological treatment to help get the new trees off to a good start. Trees have been sourced from a Woodland Trust approved Nursery in Suffolk that specialises in locally sourced stock and from the East of England Apples and Orchards Project.

4 Planting plans Swaffham Recreation Ground

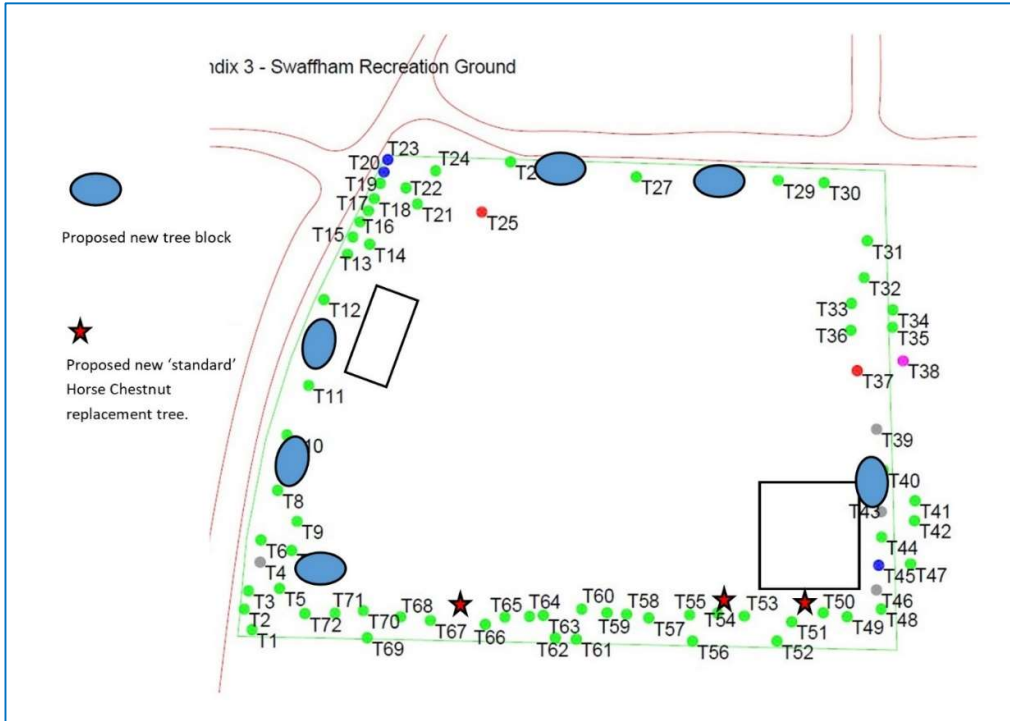

Swaffham Cemetery

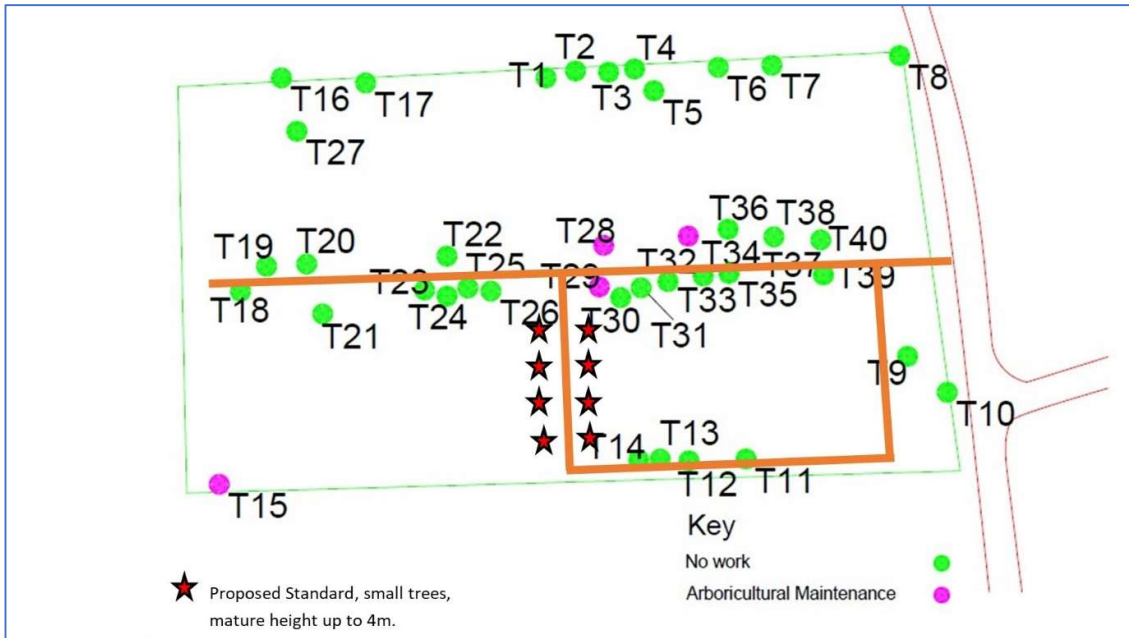

Merryweather

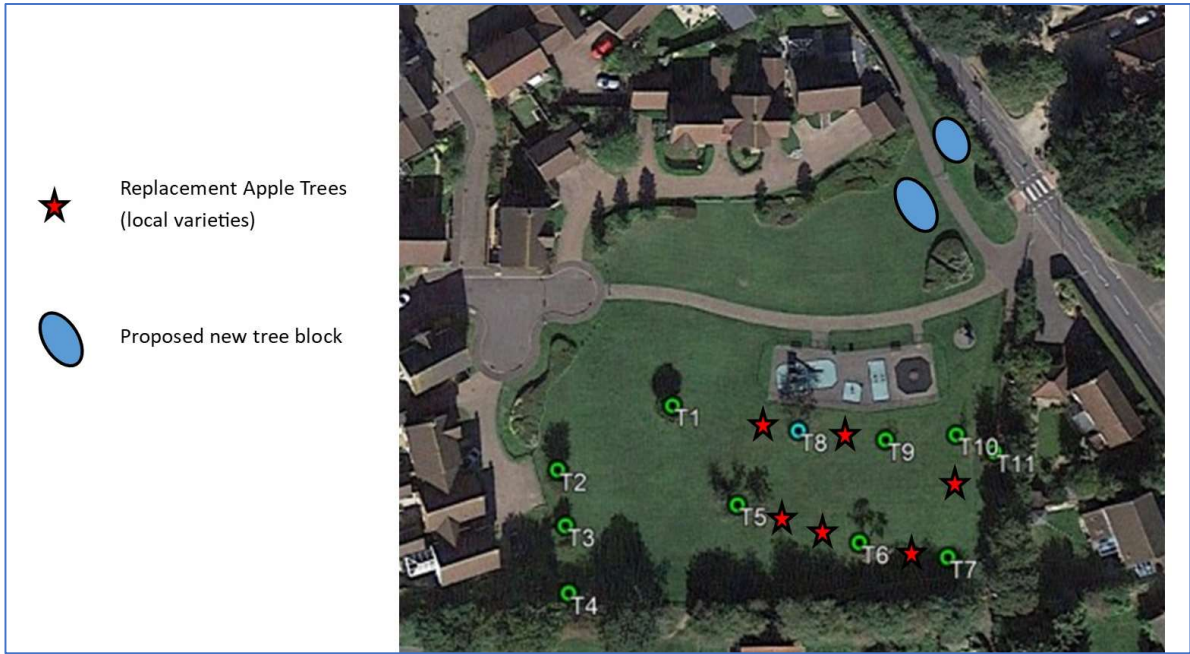

Campingland



Graham West, Sue Dent

March 2021