

Work Instruction Number 109 - "Workforce in Road" signs (Relaxation Works)
 All Amberon "Traffic Management Installations or Removals on any main road or approaching road works 40mph and above" (unless the site specific risk assessment deems it necessary on lower speeds of 40mph) must display the "Workforce in road Slow" sign, this being the 1st Sign out and last sign in.

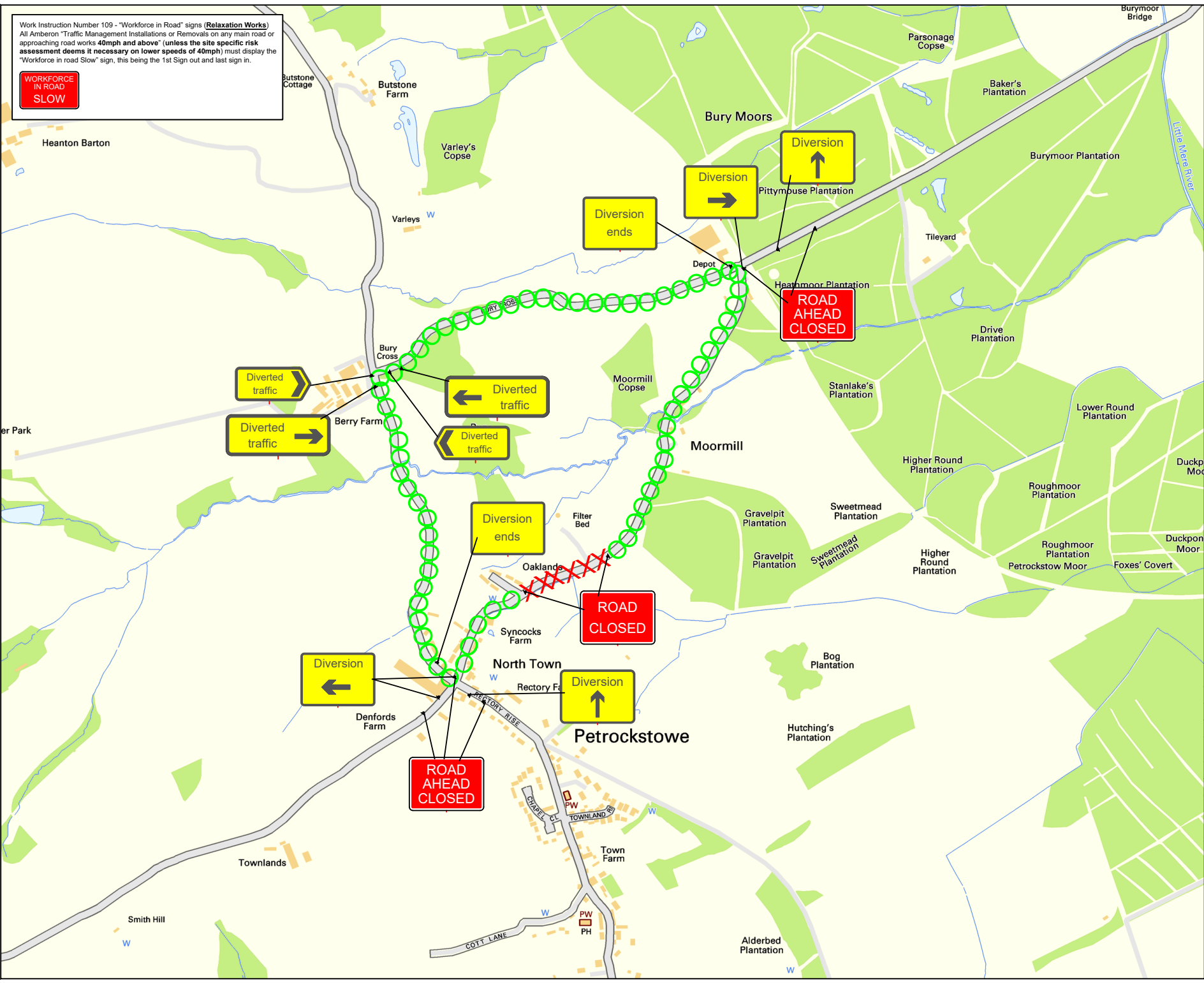

TRAFFIC MANAGEMENT NOTES:
 1) All temporary traffic management shall be in accordance with Chapter 8 of the Traffic Signs Manual 2009.
 2) All temporary traffic management shall be in accordance with the Traffic Signs (Amendment) (No 2) Regulations and General Directions 2016.
 3) All temporary traffic management shall conform to the Safety at Street Works and Road Works, A Code of Practice.
 4) All temporary traffic management signs should be located 450mm min from the kerb face.
 5) All temporary traffic management sign locations are indicative and are subject to on site approval from the Engineer.



Key

- Traffic sign
- Traffic cone/cylinder
- No waiting cone
- Pedestrian barrier
- Road closure
- Diversion route

Checked by: DAVE MOORE
 Customer: DETECTRONIC
 Job Reference:
 Location: NORTH TOWN, EX20 3HE
 Date: 02/05/2023
 Description: Road Closure
 Scale: NTS

Amberon Ltd
 Tel: 0845 371 5050

Produced By: JOSH HARPER
 Drawing Ref: 02/05/2023 - JH - 5436
 This Drawing is subject to Copyright and remains the property of Amberon Ltd.