

Elmsted with Hastingleigh
Community News

*St. James the Great
Elmsted*

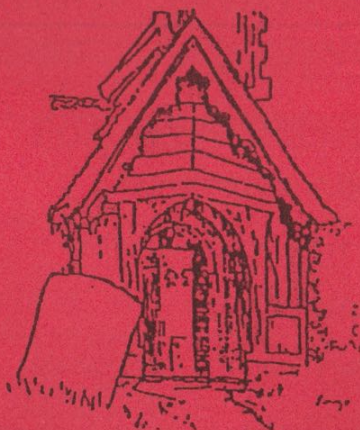
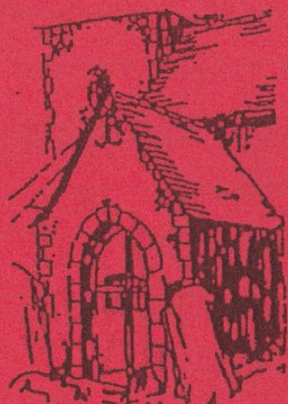

*St. Mary The Virgin
Hastingleigh*

April 2013 **40p**

THE UNITED WYE BENEFICE

Priest-in-charge

Revd. Ravi Holy

The Vicarage, Wye

01233 812450

Ravi.Holy@wyebenefice.org.uk

Associate Priest

Revd. Madi Strong

(with special responsibility

The Vicarage, Hastingsleigh

For the parishes of Hastingsleigh,

01233 750260

Elmsted, Petham & Waltham)

Madi.Strong@wyebenefice.org.uk

ST. JAMES THE GREAT, ELMSTED

Churchwarden:

Mr Chris Jeffery

01233 750223

Hon. Secretary PCC:

Mrs Ann Burton

01233 750430

ST. MARY THE VIRGIN, HASTINGLEIGH

Churchwarden:

Mrs Roz Bacon

01233 750327

Hon. Secretary PCC:

Mrs Selina Farnfield

01233 750450

PARISH WEBSITES

www.elmstedpc.kentparishes.gov.uk

www.hastingleighpc.kentparishes.gov.uk

COMMUNITY NEWS

Editor

Mrs Sheila Burrage 01233 750375

4, The Bowl Field, Hastingsleigh

Advertising Manager

Mrs Sarah Pell

01233 750296

Little Coombe, Hastingsleigh

Closing date for material: 15th of the month prior to publishing via

elmstedwithhastingleighnews@yahoo.co.uk

General Builders and Property Maintenance



All aspects covered



Free Estimates



*Glenn Young 01233 750520
Colin Blaskett 079 6885 3556*



Seasoned logs available, free local delivery

PAINTING & DECORATING

DAVID FARNFIELD

**FOR ALL YOUR DOMESTIC DECORATING
NEEDS**

INCLUDING SASH WINDOW RESTORATION

AND WALLPAPERING

FREE Estimates

Mob: 07710 130275

Tel: 01233 750450

Email: enquiries@davidfarnfield.com

www.davidfarnfield.com



Tree Work And Fencing

Contractor

- Tree surgery work undertaken: Trees shaped, reduced, or removed.
- Hedge cutting.
- Stump grinding.
- Garden fencing supplied and erected
- Hedges planted
- Composted wood chips for mulching flower beds, supplied in bulk by small tipper.
- 25 years local experience, fully insured.

Toby Gardener
Beriscolt
Hastingleigh



Tel/text mob: 07831473981
Evening: 01233 750489

Email: tandrgardener@btinternet.com

Vince Martin Carpentry and Decorating

For all your Home Improvements, and Maintenance, carried out by a Local Quality Tradesman with over 30 years experience. Work on Period Property a Speciality.

Prompt reliable service and very competitive rates. Ring for a Free No Obligation Quotation.

Absolutely **NO JOB TOO SMALL**, including, Doors, Flooring, Wardrobes, Kitchens, Windows (including repairs), Shelving, Fencing, Garden Decking, Decorating (internal and external), Wall and Floor Tiling, All Internal and External Maintenance.

Ring Vince for a Free Quotation

Home: 01233 750521

Mobile: 07860 393023

Or you can email me: vmartin555@btconnect.com

Southview, The Street, Hastingleigh, Ashford, Kent. TN25 5HU.

WYNCOT KENNELS and **CATTERY** (Hastingleigh)

**FOR COMFORT AND PEACE OF MIND
WHERE A WARM CARING ATMOSPHERE
IS ALWAYS AT HAND**

**HEATED KENNELS AND CATTERY
FULLY LICENCED, FULLY TRAINED & CARING STAFF**

SPECIAL DIETS CATERED FOR

**Set in 9 acres overlooking the picturesque Kent Downs, we have 3 large paddocks
where the dogs are individually exercised and played with**

**INSPECTION WELCOMED
(8.30 - 11.30) - (2.30 - 5.00)
7 days a week**

Phone 01233 750323 for any further details

Wye Beauty

- Electrolysis - permanent hair removal
- Waxing - 2 types of wax available
- Aromatherapy/Swedish body massage
- Red Vein, Skin Tag and Milia treatment
- Ear Piercing
- Facials
- Microdermabrasion
- Manicures/Pedicures
- Spray Tanning - very natural colour
- I P L hair removal
- Dermal Fillers
- Semi-permanent makeup
- Gift Vouchers

Closed Mondays

32 years experience. Mature staff.

29 Bridge Street, Wye. TN25 5ED

Tel: (01233) 811550

Mrs Robyn Gardener AABThC BABTAC

www.rtbs.co.uk

Chris Dryland

Property Maintenance

*Decking ~ concreting ~ sheds ~ pergolas ~ weatherboarding
Fencing ~ boundaries ~ minor electrical ~ decorating ~ guttering
small projects ~ large projects ~ emergencies
Most aspects of Household and Garden Maintenance*

References available

Also:

Tipis for hire

www.bighilltipis.co.uk

For reliable service tel. 01233 750350 or 07983 242787

e-mail chrisdryland1@gmail.com

BODSHAM HOLIDAY LETS

www.bodshamholidaylets.com

The SMITHY

Two Bedrooms
Beamed lounge with wood burner
Fully equipped Kitchen
Bathroom
Enclosed garden

The BARN

Two Bedrooms
Open lounge, diner
and kitchen
Shower room

01233 750042/07989 584801

info@bodshamholidaylets.com



BUILDERS Ltd

Restoration & Extensions of Period Domestic Property
House Building and Conversions
Design and Planning Services

Prospect Farm House, Lees Road, Brabourne Lees, Ashford, Kent TN25 6QE

Directors: J.E. and C.M. Browning Bsc (Hons), MCIOB, MASI

Telephone: 01303 813459
VAT Registration No: 661 7887 90

THE TIMBER BATTS INN

School Lane, Bodsham, Kent TN25 5JQ

TEL:01233 750237

www.thetimberbatts.co.uk email:hello@thetimberbatts.co.uk

Closed Sunday nights, all day Monday & Tuesday Lunchtime
All well-behaved dogs are welcome at The Timber Batts

Bar Menu, Snacks Menu

Take Away available

Menu du jour

(Wed-Sat Lunch)-Two course £16.00 or three courses£20.00

Sunday Lunch menu

Two course £ 20.50 or three courses £ 25.65

A La Carte Menu available all week

2013 Magic Evenings with Etienne Pradier only at The Timber Batts
20th March, 30th April, 22nd May, 19th June, 14th July, 27th August,
24th September, 29th October, 26th November



Domestic
Installer
Scheme

EDWARD YOUNG

ELECTRICAL INSTALLATIONS &
SECURITY SYSTEMS

Registered Electrician.

Established over 30 years.

All types of installation work carried out.

Fault finding & Repairs.

Farm - Domestic - Commercial

Telephone: 01303 813654

Mobile: 07702 640237

Joy Gaitskell

Designer—Dressmaker
(based in Wye)

Bridal Wear, Curtains and Soft Furnishings
Professional Alterations

Do call to discuss your requirements

01233 811507

ROZ BACON

Moonraker, The Street, Hastingleigh,

Ashford, Kent TN25 5HU

01233 750327 (ans)

roz.bacon@btinternet.com

BED & BREAKFAST

Roz is a qualified Guide to the City of

Canterbury and Cathedral Guide

Delightful rooms in a lovely village

AJ Fortescue & Son Ltd BUILDERS & CONTRACTORS

NEW BUILD, EXTENSIONS,

ALTERATIONS,

REPAIRS, GROUNDWORK

Waterside Farm, West Brabourne,

Ashford, TN25 5NA

Tel 01303 813108

E-Mail:

office@ajfortescueandson.co.uk

Reena Platt

Sewing - repairs, alterations, curtains etc

Tel: 01233 650737

THE DEVIL'S KNEADING TROUGH RESTAURANT

Open 7 days a week

10.30 to 5.30 Monday — Saturday 10.30 to 6 — Sunday

(1st March - 31st October depending on weather)

10.30 to 4.30 7 days

(1st November—28th February depending on weather)

Evening Restaurant—Friday & Saturday

(Please book in advance)

Fully licensed for weddings - Coach parties welcome

Christmas Parties, Children's Parties etc. catered for

bookings@devilskneading.co.uk

Tel. No. 01233 813212

LEARN FRENCH LOCALLY

Any age, any level, day or evening

Individual or small group

Helen Hewson

Tel: 01233 750589

CHILHAM FEEDS



01227 731159



9am - 5pm weekdays, 9am - 1pm Saturdays

Wide variety - Friendly service - Reasonable prices - Large stocks

For Horses, Dogs, Cats, Sheep, Goats, Pigs, Poultry, Rabbits, Birds, Fish etc.

Bedding - Vitamins - Supplements - Conditioners - Accessories

East Stour Farm, A28 Godmersham, Nr Chilham, Kent

SARAH de ROUGEMONT

Upholstery

07973 377817

01227 455841



- Upholstered furniture
and renovation

- Loose covers etc.

- All commissions considered

LOCAL WINDOW CLEANER



Contact Paul Boxall

01233 750206

Style Matters

design and print

Brochures, programmes, fliers
Wedding and personal stationery
Proofreading and research services
Word processing
Colour/black and white printing, copying, scanning

Telephone: 01233 750425
e-mail: kerry.relton@googlemail.com
jill.relton@tesco.net

MICHAEL RUST

LETTERING AND CARVING STUDIO



Sculpture and carving in wood and stone.
Architectural lettering in stone, wood and engraved glass.
Memorials and inscriptions designed and cut in the finest hands.

The Studio, Sycamore Barn, Tamley Lane
Hastingleigh, Ashford, Kent TN25 5HW
Telephone: 01233 750305
Email: michael@studiorust.co.uk www.studiorust.co.uk

Evington Community Project

SPRING FAIR

MONDAY 6TH MAY

ON THE FOOTBALL FIELD FROM

SPRING
RAFFLE

12.30

TOMBOLA

CRAFT STALL

BEER TENT

SWEET SHOP

TEAS &
CAKES

BBQ

SIDE SHOWS

FOOTBALL SPEED
CAGE

PLANT SALE

BODSHAM SCHOOL
CHOIR

BOUNCY
CASTLE

CANDY FLOSS

CHILDREN'S
RACES

FACE PAINTING

Art & Craft Exhibition in Evington Village Hall (from 2pm)

ECP PRESENTS

A Fish and Chips Supper and Film Night

SATURDAY 13th APRIL 2013

EVINGTON VILLAGE HALL

Fish and Chips Available From
7.00 pm

Entry Free

Due to restrictions imposed by our licensor we are not allowed to advertise the name of the film in the Community News.

To find out more and to book your fish or sausage and chips and/or reserve your place please contact

Robin Helmer on 01233 750236

robin.helmer@btinternet.com

It is also possible to have "take-away" fish and chips, i.e. take them home and not watch the film, but you do need to order in advance

theWI
INSPIRING WOMEN



Come and join us for a three-course supper
and help us raise money for the

Kent Air Ambulance

Friday, 10th May 2013

7.00 for 7.30 pm

In the Evington Hall

Only £7.50 per person
(Bring your own wine)

Please let us know if you can come by

Friday, 3rd May by contacting:

Mrs Jill Argar on 01233 75031

or Mrs Jean Bowes on 01233 811875

or Mrs Yvonne Helmer on 01233 750236



Kent Air Ambulance Trust
saving time - saving life

HASTINGLEIGH with ELMSTED WI

Fourteen members met in the Evington Hall on 7th March. With Mrs Jill Argar presiding, various upcoming dates and meetings were discussed including where to go for our birthday dinner in May as the hall will be in use as a polling station for the local elections.

We were pleased to welcome back Ms Sarah Grazebrook to talk about her new book "The Shadow of the Lamp." She chose this title because she wanted to write the story from the junior nurses' point of view rather than centring it on Florence Nightingale but she found Miss Nightingale to be such a strong feisty character that this was very difficult. The two girls we follow in the tale are very different, one a butcher's daughter, interested in anatomy from seeing and handling animal carcasses in her father's shop. The other from a well to do family, only in it for the glamour, which of course was not there.

Florence came from a wealthy background and was well educated but to her parents' dismay was more interested in Mathematics and Anatomy than the ladylike subject they would have preferred her to favour.

The opportunity to go on the grand tour with friends gave her the chance to break away from what was expected of a young lady in the 19th century and while in Germany she visited a penitentiary for fallen women and orphans. This made her sure that she must do something about such human suffering.

Then came the Crimea War, which the powers that be set out to fight as they had forty years earlier at Waterloo. By now telegraph had been invented and people at home could read in the papers what was happening out there in a matter of days, instead of having news that was two months old. Florence persuaded the War Office and was finally given permission to take a band of nurses to the war zone. Out of 283 girls interviewed, only 14 were deemed suitable so she agreed to take nuns as well. On arrival all help was refused. The officers in charge would not believe that it was the conditions in the hospital that were killing the men, not their wounds. It was a French war artist that turned the tide with his picture of the lady with the lamp appearing in a London newspaper and I suppose that was the start of nursing as we know it.

On April 4th our speaker will be Mr Robert Stichbury and his subject "Hearing Dogs" Please bring any used postage stamps and old mobile phones both of which can be turned into funds for this charity. B.M.G.

EVINGTON GARDENERS

PLANT SALE

MONDAY 6th MAY

12.30 pm – 5.00

FOOTBALL FIELD HASTINGLEIGH

EVERYONE WELCOME

WE JOIN THE SPRING FAIR THIS YEAR!

COME AND BUY LOTS OF LOVELY PLANTS

SUPPLIED BY WILL DENNE

Please note change of date and venue

MY ILLNESS AND RETIREMENT

Ah, got your attention. I planned to take 24 hour retirement in April and return to work. What I did not plan was the need for a major operation in the lead up to that date!

It has been an interesting period being a patient and I have been treated fantastically well both by my doctors and the surgery team who I am burdening with extra work. Jess Crouch is on maternity leave at present and so there will be some new faces in the surgery, we have been very lucky to get hold of some very good locum GPs to replace the hours lost by my and Jess' absence.

I will be away for four weeks after which I will be working two days a week for another month before returning full time.

Lets do a bit of disease prevention this month as it seems very apt.

STOP smoking! It's never too late. One in two older smokers will die because they smoke, one in two! But if you stop smoking now you reduce that risk by 25%, one in four, even at this late stage. That's remarkable isn't it? I couldn't believe my ears when I heard fags were £8 a pack now, that's bonkers money! Electric cigarettes probably reduce the risks but stopping is the answer. It is THE most affective way of stopping progression of smokers lung to the end stage of agonising breathlessness at rest.

'Oh but I've tried doctor'. Well smoking cessation one to one sessions double the chance of quitting and champix has a similar additional benefit, it is a tablet you take for 12 weeks that stops the urge to smoke. It can increase the risk of depression so must be used with caution in those with a tendency to depression. It's twice as effective as bupropion which we used to use.

Aspirin and cancer. There is evidence that aspirin reduces the risk of getting cancer and reduces likelihood of spread by 30-40%, it also reduces 5 year mortality. There is an increased risk of bleeding from the stomach so some may need stomach protection pills. There is no general advice for people to start aspirin en masse at present but it is an interesting finding.

Iron in non anaemic women who have periods. An interesting study found that women who menstruate but are not anaemic have an increased tendency to what we call TATT, tired all the time. If they had low iron stores, ferritin, a small amount of iron a day improved these symptoms. 50% in the iron treatment group felt better versus 30% in the placebo group, inactive placebo is a potent drug In all trials.

Well that's it for a couple of months, bear with us at the surgery, we always work hard to provide the best service possible even in adversity.

ELMSTED CHURCH

LUNCHES & TEAS

Sunday 26th May

12 noon—4pm

St James the Great, Elmsted

Competition

Make an animal using fruit and vegetables



Classes: - 8 & under, 17 & under, 18 & over

FOR SALE

Plants & Produce

LIVE MUSIC

By the

FOURTUNERS

Come and enjoy a relaxing afternoon in a glorious, peaceful setting

CHURCH SERVICES FOR ELMSTED & HASTINGLEIGH

7 th April Easter 1	10.30 Benefice Service at Brook	
14 th April Easter 2	10.00 Family Service at Bodsham School	
21 st April Easter 3	11.00am Hastingleigh: Family Communion (CW)	5.00 Elmsted: Evensong
28 th April Easter 4	9.30 Elmsted: Parish Communion (CW)	11.00 Hastingleigh: Holy Communion (BCP) 4.00pm Sunday Teatime in Evington Hall Hastingleigh

Sunday Teatime: At Sunday Teatime we have fun, do new things, create, chat and worship. Great food! Great people! And open to **ALL AGES!**

Give it a try – even if it's just for the tea!

LOST

**2 Trays are missing from the village hall kitchen.
If you have these or know their whereabouts please
could you
return them to the hall or Avis.**

CHURCH FLOWER AND CLEANING ROTA

	St. Mary's Hastingleigh	St. James' Elmsted
Apr 7th	Mrs Bowes	Mrs Browning
Apr 13th	Mrs Helmer	Mrs Jeffery
Apr 20th	Mrs Morris	Mrs Argar
Apr 27th	Mrs Waters	Mrs Francisconi



DATES FOR YOUR DIARY

Wed 3rd	Coffee Morning	10.30am
Thurs 4th	Women's Institute (Pages 15 & 16)	7.30pm
Fri 5th	Youth Club	7.00pm
Tues 9th	Hastingleigh Parish Council Meeting	7.45pm
Fri 12th	Charity Whist Drive	7.00pm
Sat 13th	Film Night (Page 14)	7.00pm
Sun 14th	Footpath Walk	2.00pm
Tues 16th	Gardeners Society Annual General Meeting (Page 17)	7.30pm
Sun 28th	Sunday Teatime	4.00pm
Mon 29th	St John of Beverley AGM	8.00pm

Note: All events at Evington Hall unless otherwise stated.
Parent & Toddler Group meet every Tuesday - 9.30am
Mobile Library every Wednesday 10.55am - 11.20am
Art Group meet on Thursdays 9.30am - 12.30pm

INSPIRED?

Where do we look for inspiration? Maybe we shouldn't look because maybe it's just a matter of waiting. If we are thinking in terms of being inspired by the Holy Spirit, then we probably have to 'be still' and wait on the Lord. If you are looking for inspiration for a sermon or a Parish Magazine article it can be a bit trying when that inspiration does not come immediately!

I got lucky a couple of weeks ago at the Ashford Tip/Re-Cycling Centre; a very insalubrious and basically ugly place.** But it is a place that deals with "life" and all its ramifications. I saw items that have been a part of the lives of many people, who for some reason best known to them have decided to divest themselves of what is now surplus to requirements. Looking at the rubbish in the container for scrap metal alone, I found myself reflecting on certain items that lead me to think about why they are no longer of any use. Some were quite obvious – a broken pram, a wheelbarrow, a sled, some empty paint tins, part of a child's climbing frame, and a zimmer frame (did Granny die?). All these things once had a use and were part of the lives of the people, things to which they were attached yet now found that it was time to get rid of them.

During Lent we were called to 'prayer, fasting and almsgiving' – though of late I haven't run into many people who actually do much fasting! Ravi's sermon on the 3rd March gave us an idea that he didn't think much of 'fasting or self-deprivation', but suggested we find some more positive things to do. You may not want to give up chocolate but Lent is a good time to examine our attachments, and what we most highly value and are not willing to give up; that is often quite uncomfortable because we are faced with things that matter most to us in our day to day lives. It means making choices and working out priorities without fudging the issue. A good time to remember Jesus' words: "where your treasure is, there will your heart be also".

It is my dearest hope that as you read this at the end of March, that we will be finished with the snow and that the darkness of Lent will feel far behind, and that whether or not you're a 'regular' member of our congregation, or a High Day and Holiday Visitor, please do come to rejoice and celebrate the resurrection of our Lord on Sunday. As I write this just after Mothering Sunday I believe that continuing in Gods grace I may be there to share the joy with you.

This threefold formula for Lenten observance opens the door for us into that spiritual realm where we can in fact become the person God wants us to be. Wye is a caring and generous community, so I know for most of you almsgiving is not much of a problem; my family had first hand experience of this for which we are, and will be, eternally grateful; but prayer? that is often a stumbling block for many because they think they need the right words. It won't be, if you allow the Spirit to come and don't try too hard, Brother David in the book *Altar on the World* advises those of "you who struggle.

"*Prayer* is not the same thing as *prayers*. Prayers are important, saying psalms in the morning is a good way to head into the day more prayerfully, so is going to church, but prayer is waking up to the presence of God no matter where you are or what you are doing. When you are fully alert to whoever or whatever is right in front of you;

when you are electrically aware to the tremendous gift of being alive; when you are able to give yourself wholly to the moment you are in, then you are in prayer. Prayer is happening, and it is not necessarily something that you are doing. God is happening, and you are lucky enough to know that you are in The Midst. May this Easter season bring you joy, inspiration and love.

Dickie

***Yes there is still one in Ashford – a little further along the same road- set up because of the hue and cry of the citizens!*

FROM THE EDITOR

Let's hope that by the time this April magazine reaches you that spring will at last have arrived. There is a new look to the magazine this month. First, a thank you to our advertisers; their annual contracts have been renewed and there are some new ones. Second, the "news" is still in the centre group of pages, but the details of organisations and other useful contacts are now inside the front and back covers. This should make them easier to locate and also simplifies organisation of the printing.

Subscriptions for the year are nearly all in, but there are still one or two outstanding. If you wish to continue to receive the magazine your distributor would appreciate prompt payment.

2013 at the Timber Batts

MAGIC EVENING WITH ETIENNE PRADIER

WEDNESDAY 20TH MARCH, TUESDAY 30TH APRIL, WEDNESDAY 22ND MAY

WEDNESDAY 19TH JUNE, SUNDAY 14TH JULY, TUESDAY 27TH AUGUST

TUESDAY 24TH SEPTEMBER, TUESDAY 29TH OCTOBER,

TUESDAY 26TH NOVEMBER

IN THE GARDEN

This month we begin to think seriously of spring and the coming summer. There is a need to get some plants in preparation. The season here is shortened by as much as 2 weeks in the spring and 2 weeks in the autumn as we are 600ft up. Any way we can overcome this is desirable. If you have a greenhouse or handy light windowsill you can plant the seeds of half hardy plants. When these have germinated the seedlings can be planted out into modules. Alternatively you can plant the seeds directly into the modules. With a little bit of effort one can have a good supply of plants for planting out later in the season. You can buy in plants already germinated in modules from the garden centre. These can be potted on producing plants at less than half the price. It is a good time to start this now as the garden centre plants are fresh and have not been sitting in poor light for a few weeks. Avoid large pots as this is costly in compost. Some plants tend to fail if too large a pot is used. Make sure the plants are kept in plenty of light. The advantage of producing plants in pots is there is little disturbance of the roots when they are planted out so they will grow away more quickly. The same principles can be applied to vegetable plants, particularly leeks, onions, cabbage etc.

There is still time to divide up the perennials in the border. As the new shoots appear the position of the plants becomes clear. I find splitting many of the border perennials that have been in place several years stimulates new growth increasing the number of flowers. Splitting the plants provides the opportunity to add fresh compost to the soil. It provides more plants to install to enlarge areas or introduce into a new area. Flower beds need larger areas of single variety flowers to give more impact or rows (pathways) of uniform plants snaking across the border. The splitting of the perennials would provide the extra plants needed without expense.

The coming month will be a busy time of preparation for the summer but don't forget the basics. Apply a general fertilizer such as "Growmore" and compost to improve soil fertility. Watch out for slugs on the emerging shoots and remove those weeds while they are still small! **SB**

EVINGTON COMMUNITY PROJECT

ANNUAL GENERAL MEETING

Chairman's Report for 2013

We held a successful Spring Fair on the 7th May 2012 which boosted our funds by just over £900. We have ploughed all the money raised back into our community by arranging sporting and leisure events that are either free or heavily subsidised and by offering financial support to village organisations.

We organised three Film Evenings with Fish and Chips during the year, which continue to be very well supported. We supported financially and arranged, in association with some of the other village organisations, the Elmsted and Hastingleigh Celebrations for HM The Queen's Diamond Jubilee, which included a street party outside the hall, an official Jubilee Beacon and a Jubilee Mug for all school-age children in our two parishes. We cooked and served food for the Bonfire and Fireworks night, which raised £95 for the Kent Air Ambulance and we gave a sizeable donation towards the cost of the fireworks. Sadly, our coach trip to London in September did not attract sufficient numbers to make it viable. However, we are hoping to help resurrect a village trip to France or Belgium in 2013. We continue to assist financially with the maintenance of the Playing Field.

In October 2012 we started a Youth Club which is kindly run by Annika Kirton, assisted by Rachel Palmarini and James Farr..

At the end of 2012, we held our annual "Seasonal Thanks" morning of Mulled Wine and Mince Pies, to say thank you to the residents and friends of our two parishes who have generously supported ECP throughout the year. This was well attended.

I should like to take this opportunity to thank the Evington Community Project committee who have worked tirelessly throughout the year and have given freely of their time. I should also like to thank on behalf of ECP, The Powell Family for allowing the use of their field; Sarah Pell for checking our accounts; Elmsted and Hastingleigh Parish Councils and all of you who have generously supported and assisted with our events throughout the year.

Robin Helmer

4th March 2013

FOOTPATH WALK - 17th MARCH

Two Forward and One Back!

So would we, could we, make a go of it this month or would the weather stop us yet again. Having survived the blizzard at the beginning of the week and the torrential rain the day before it was with some trepidation that ten of us met at Little Coombe for an afternoon stroll.

Leaving by the bridle way toward the north west very soon I was reminded of that famous Flanders and Swann song - "Mud Mud Glorious Mud", and that's pretty much how it stayed!

After a while we took a right hand path across the fields to Hassel Street and then on to what is normally a lovely path to Crundale. Turning left here we dropped down to the Crundale Downs path back towards Pett Street Farm. By the time we had reached the farm everyone was beginning to feel the effort of taking two steps forward and one back, plus the need to carry large parts of Kent on the bottom of your boots.

Miraculously only one person fell over and fortunately not hurt. We had to wait at the farm for those wonderful countryside visitors – motorbikes – how they can get enjoyment out of the beautiful Kent downs beats me.

A final walk through the wood to Big Coombe gave us some much needed relief from the mud as the footpath was in reasonably good shape. At Big Coombe two of the party left to take a short cut to Barbara's while the rest of us worked our way up the hill and back to Little Coombe.

Perhaps not our most pleasant walk ever but as always a very happy time with lots of good conversation

Why not try next month's walk which will be in the spring sunshine on the 14th April, probably starting at the hall.

ART AND CRAFT EXHIBITION

In conjunction with the May Fair on May 6th
the village hall will be open for our
usual art exhibition.

If anyone would like to exhibit in any medium
your contribution would be most welcome.

Please contact Val Kerry 01227 700843
or Sheila Burrage 01223 750375.

✎ *Imaginative design
service*

🪵 *From single items*

📐 *to full room plans*

🪵 *From budget basic*

🪵 *to dovetailed hardwood*

🔧 *Kitchen fitting service*

😊 *Repairs & alterations*



07715 565030

01227 700883

Christmas Cottage
Richdore Road
Waltham
Kent CT4 5SH

bengrillet@btopenworld.com

STARS OF INTERNATIONAL OPERA

When I look back on seven years' of Hundred Shows, 2010's "Rising Stars of Opera" shines out. Its commanding baritone, **James Cleverton**, returns to **Petham Village Hall** in an established trio of established singers on **Saturday April 13 at 7.30**.

James's repertoire includes Escamillo in Carmen, Figaro in The Barber of Seville, Don Giovanni and Eugene Onegin for such companies as **English National Opera, Royal Opera House, Covent Garden, Salzburger Festspiel and Zurich Opera**. His gift for comedy makes him also a leading performer of Gilbert and Sullivan. Soprano **Mary Plazas** has sung regularly at Covent Garden and Glyndebourne and as a Principal at English National Opera. Her roles include Mimi in **La Boheme**, the leading soprano parts in **Marriage of Figaro, Don Giovanni** and **Così fan tutte**, and Janacek's Cunning Little Vixen, as well as creating notable roles in new operas. Solo recitals at Wigmore Hall, The Purcell Room and Karajan centre in Vienna are matched with solos in Mozart's and Brahms' Requiems.

Starting as a St Paul's chorister, **James Edwards** has sung leading tenor roles in **Albert Herring, The Rake's Progress**, as Roderigo in **Otello** and **Lensky** in **Eugene Onegin**, has performed with the Philharmonic Orchestra in Verdi's and Mozart's Requiems and lately played Don Jose in Carmen at the Royal Albert Hall. The singers are accompanied by **Ian Ryan**, staff répétiteur with Scottish Opera for three years with similar experience at Opera North, ENO and The Edinburgh Festival. As a soloist he has performed at the BBC Proms and the Musikfest Berlin.

Tickets with a glass of wine or juice are £19.50 (adults) and £10 (students) from 01227 700 847 or 700327

In Aid of The Lord Whisky Sanctuary Fund

Registered Charity: 2843483

Park House, Stelling Minnis, Kent CT4 6AN

Tel: 01303 862622 Fax: 01303 863007

Website: www.lordwhisky.co.uk ~ Email: lord.whisky@btinternet.com

Boot & Spring Fayre ~ Saturday 4th May

at Park House, Stelling Minnis CT4 6AN

Boots from 8am ~ Cars £6.50/Vans £10 (£6/£9.50 if pre-paid)

Entertainment from 12 noon - 3.30pm

Hythe Town Concert Band ~ Layla Belly Dancing

Hawkinge Flyers ~ Anthea Barnes School of Dancing

Hot & Cold Refreshments ~ Raffles ~ Tombolas & more!

Admission by donation ~ Plenty of free parking~

4th Annual Cyclo-Sportive

Bank Holiday Monday, 27th May

From 9am at Park House, Stelling Minnis

For further information, email: nickracingsnake@btinternet.com

Entry forms can be downloaded from our website

~~~~~ ~~~~~ ~~~~~ ~~~~~ ~~~~~ ~~~~~

### Visit the Lord Whisky Tearooms and Gift Shop

At Rhodes Minnis CT4 6XY

Open daily from 10am - 4pm. Tel: 01303 862349

Freshly prepared Breakfasts, Lunches, Teas and Snacks

Open Wednesday & Friday Evenings from 6pm - 9pm

Sunday Roasts

Home-made cakes ~ Good Quality Bric-a-Brac and Lord Whisky Gifts



**BUSINESS:** Board Meetings, AGMs, Dinners, Training, CPD, Christmas parties

**FAMILY CELEBRATIONS:** Civil Ceremonies, Wedding Receptions, Birthday Parties, Christenings, Anniversaries & Wakes

**CLASSES:** Pilates, Work-Out, Singing, Yoga + Piano Lessons & Beginners' Tennis Coaching.

**EVENTS:** Open-Air Shakespeare; Plays; Yoga, Photography & Beauty Workshops; Christmas Fair and more: see website

*Squash, Swimming (summer only)*

*Charlton Place, Canterbury CT4 5JA*

## AERIAL VISION

### INSTALLATION AND REPAIRS

DIGITAL TV AERIAL SPECIALIST.  
SATELLITE TV (SKY/FREESAT).  
TV WALL MOUNTING.  
RECEPTION PROBLEM SOLVING.

EXTRA TV POINTS  
FREE ESTIMATES  
NO VAT  
LOCAL FAMILY BUSINESS

GLEN MARTIN

**01233 740701 / 07789 833396**



### An Acupuncture Clinic at Wye Surgery Wednesdays from 9.30am to 6.00pm

Please enquire if you suffer with any of the following conditions:  
Pain such as sciatica, back or neck ache, frozen shoulder and arthritis  
Digestive disorders such as IBS, chronic diarrhoea or constipation and bloating  
Gynaecological disorders such as PMT, irregular or painful cycles and menopausal symptoms

Supportive care during conception, pregnancy and/or induction  
Stress, migraines and mood disorders  
Hay fever, colds and flu  
Home visits available

0844 387 8419 (appointments)

077 898 40676 (to contact Heidi)

### ALL CREATURES GREAT AND SMALL

House and pet sitting service

01233 714682 - 07942 045286

CRB Checked

**Dawn Busby**

Insured

Good References available

### RICHARD GILBERT PLUMBING & CENTRAL HEATING

Established 25 years

Oil & Gas Central Heating Specialist – OFTEC & Gas Safe Registered –  
Landlord's Gas Safety Certificates.

Wood Burning Stove Installations - HECTAS registered

Full central heating installations and systems updates, oil boiler and oil tank installation and replacement, gas boilers, fires, cookers and hobs.  
Chimney sweeping and Flue Liner installations.

**All Domestic Plumbing including** – Power flushing, unvented hot water systems, bathroom and showers including tiling, hot water cylinders, water softeners, sink, dishwasher and washing machine installations, replacement radiators and thermostatic valves.

Telephone 01233812566

Mobile 07860 877836

# MARY HEMSLEY

## INTERIORS

"the complete service"

- Curtains
- Designer fabrics
- Tracks and Poles
- Blinds
- Wallpapers
- Upholstery

### Little Greene Paint

design ideas and advice

**01233 813717**

150 Bridge Street, Wye, Ashford, Kent. TN25 5DP



### YOGA CLASSES

#### WALTHAM VILLAGE HALL ON MONDAY EVENINGS

*Suitable for absolute beginners to experienced students;  
men or women and a wide range of fitness levels.*

*Yoga will help with flexibility, stretching, relaxation and stress.*

**I ALSO OFFER A VARIETY OF MASSAGE TREATMENTS**  
*to ease stiff joints, promote health and well being and for stress management.*

*(Fully qualified-ITEC/LCIC/Diploma in Yoga Teaching/Life Coach)*

**Phone or email for more information: Lynn 01227 700071/07913305175**

**lynn@saxby4.orange.co.uk**

## OAK FRAMED BUILDINGS

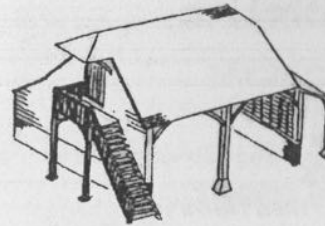

Houses, Garages, Conservatories & Sun-rooms,  
Extensions, Roofs. Design & Build or built  
from your own plans. Locally based, long  
established small company using trustworthy  
local craftsmen.

**Michael Barnes**  
**01233 812555 or 07740 870540**

## BOSSINGHAM & LANDSCAPING

EXCAVATION  
CONCRETING  
DRAINAGE  
CAR PARKS  
DRIVEWAYS  
BRICKWORK



PATIOS  
PONDS  
TURFING  
FENCING  
PLAYGROUNDS  
EQUESTRIAN ARENAS

**M: 07894 007 660      W: 01303 890 704**  
**WWW.BOSSINGHAMGROUNDWORKS.COM**

## ELIZABETH MILLER MSSCh MBChA

### Chiropodist



**TEL.**  
**01233 750200**

*Home visits by appointment*



## **SIX MILE GARAGE and ACCIDENT REPAIR CENTRE**

STONE STREET, STELLING MINNIS  
CANTERBURY. CT4 6DN  
[www.sixmilegarage.co.uk](http://www.sixmilegarage.co.uk)  
Telephone: Stelling Minnis 01227 709214/491  
Fax: 01227 709331

- \* Service and Repairs to Cars and Commercial Vehicles
- \* Class 4 and 7 M.O.T Testing
- \* Crypton Diagnostic Tuning Centre
- \* Body Repair Centre
- \* Car Sales
- \* Collection & Delivery

Forecourt Petrol & Shop

Open 7 days a week

## **1<sup>st</sup> Class Cleaning**

Weekly, fortnightly, monthly or even a 'one off' cleaning service

Many years experience and an excellent reliable service

No job too large or too small

References provided

REASONABLE RATES

Near Canterbury

01304 841489/07862 739670

Email: [clean1stclass@hotmail.co.uk](mailto:clean1stclass@hotmail.co.uk)

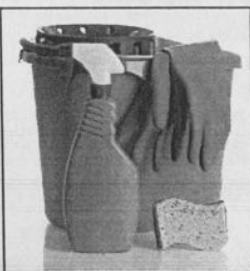

## **G.A. WATTS Electrical Installations Approved Electrician**

### **NICEIC DOMESTIC INSTALLER**

New installations. Extra points. Complete rewires.  
Appliance testing and electrical surveys.

Security lighting.  
Specialist in sympathetic  
Wiring for period properties.

For personal attention  
And free estimates  
**(01227) 709376**  
**(07973) 480241**

## **TOP QUALITY TUFTED TWIST CARPET UNDER £20 INCLUDING FITTING SELECTATWIST**



80% PURE NEW BRITISH WOOL  
ONLY £19.95SQM

**CARPETS *direct***

**01233 714999**

Selecta House, Charing Hill TN27 0NL  
[www.carpetsdirectcharing.co.uk](http://www.carpetsdirectcharing.co.uk)

Hardwood & Laminate  
Showroom  
Now Open



# S.C.S.

Cesspool / Septic Tank Emptying Service

For That Quality Service

**Southern Cesspool Services**



*All Types of Tanks Emptied*

*Septic Tanks/Cesspool Tanks/  
Treatment Plants*

*High Pressure Jetting of Drains  
Soakaways ETC*



*Regular Automatic Bookings*



**01233 646767 / 07773 491356**



Card Payment Accepted



Web: [www.southerncesspoolservices.com](http://www.southerncesspoolservices.com)

Email: [info@southerncesspoolservices.com](mailto:info@southerncesspoolservices.com)

## LOGS & FIREWOOD

**For Good Quality, Seasoned**

**Burning Wood**



**Ash or mixed logs (dry)**

**cut to order**

**Ring John Austen**

**(01227) 700570**

## AFB ELECTRICAL LIMITED

Electrical Contractor



**All electrical work undertaken**

**Please contact:**

**Andy Burchell**

**Tel: 01233 632424**

**Mobile: 07739 259953**

**E-mail: [aburchell@afbelectrical.co.uk](mailto:aburchell@afbelectrical.co.uk)**

## Containerised Storage

**available locally**

**Fully secure**

**Indoors or outdoors**

**Competitive rates**

**Please phone 01233 812237 for further  
details**





## Bossingham pre-school

- Children aged 2-5 years
- Experienced & friendly staff
- Quiet rural location
- Breakfast & after-school clubs

Situated in purpose-built premises, within the grounds of Stelling Minnis Primary School, we offer creative and stimulating activities to help the physical, social and educational needs of every child. There's an all-weather outdoor play area, optional breakfast club available from 8am and after-school club available until 6pm.

visit: [bossinghampreschool.co.uk](http://bossinghampreschool.co.uk)  
or call: **01227 709156**

## aldingtonosteopathy

The Surgery, Goldwell Close, Aldington, Ashford, Kent. TN25 7DY.

Can provide effective treatment for many conditions including:

Back and neck pain

Sports Injuries

Headaches

Trapped nerves

Arthritis

Shoulder pain

Sciatica

Whiplash

Knee problems

Ligament sprain

Also available specialist osteopathic clinics for:

Pregnancy related conditions

Cranial osteopathy for babies

**01233 720160**

[www.aldingtonosteopathy.com](http://www.aldingtonosteopathy.com)

## LOCAL ORGANISATIONS

|                                                               |              |                                  |
|---------------------------------------------------------------|--------------|----------------------------------|
| Elmsted Parish Council                                        | Clerk        | Tracey Block<br>01233 750415     |
| Hastingleigh Parish Council                                   | Clerk        | Tracey Block<br>01233 750415     |
| Evington Hall (caretaker & bookings)<br>(Treestumps, Elmsted) |              | Mrs Avis Ball<br>01233 750231    |
| Evington Hall Committee                                       | Hon Sec      | Mrs S Lawson<br>01233 750288     |
| Evington Community Project                                    | Hon Sec      | Mr D Farnfield<br>01233 750450   |
| Evington Gardeners' Society                                   | Hon Sec      | Mrs J Pearce<br>01233 750382     |
| Evington Players                                              | Hon Sec      | Mrs C Batcheller<br>01233 637955 |
| Art Group                                                     | Contact      | Mrs V Kerry<br>01227 700843      |
| Footpath Walks                                                | Contact      | Mr D Harris<br>01233 813711      |
| Women's Institute                                             | Contact      | Mrs J Bowes<br>01233 811875      |
| Parent & Toddler Group                                        | Contact      | Mrs H Wade<br>01233 750032       |
| Neighbourhood Watch                                           | Hastingleigh | Mr G Block<br>01233 750415       |
|                                                               | Elmsted      | Mr J Argar<br>01233 750311       |



**Ron's Emporium  
& Sons**



**THE BOWL INN** FREE HOUSE



**CAMRA**  
Ashford, Folkestone  
& Romney Marsh  
**PUB OF THE YEAR**  
2012

**A FINE PUB AND AN ANTIQUES BARN AT HASTINGLEIGH, KENT**

**RON'S EMPORIUM & SONS**

**OPENING HOURS**

(SATURDAY 11AM-5PM) (SUNDAY 11AM-5PM)  
WE ALSO OPEN BY APPOINTMENT

**WE BUY AND SELL ANTIQUES**

**HOUSE CLEARANCES OF ANY SIZE**

**SPECIALISING IN ANTIQUES, FURNITURE, ARTS,  
CRAFTS & THE UNUSUAL FOR OVER 30 YEARS**

**THE BOWL INN, HASTINGLEIGH**

**OPENING HOURS**

(TUESDAY 5PM-11PM) (WEDNESDAY 5PM-9PM) (THURSDAY 5PM-11PM)  
(FRIDAY 5PM-LATE) (SATURDAY MIDDAY-LATE) (SUNDAY MIDDAY-9PM)  
(CLOSED MONDAYS)

+ **LOCALLY SOURCED ALES - CAMRA RECOGNITION 2007-2013**

+ **QUIZ NIGHT TUESDAY NIGHTS - 8.30PM START**

+ **BEAUTIFUL SANDWICHES & BAGUETTES - ONLY AT WEEKENDS**

NO DOGS EXCEPT GUIDE DOGS

FOR MORE INFORMATION PLEASE VISIT [WWW.THEBOWLONLINE.CO.UK](http://WWW.THEBOWLONLINE.CO.UK) OR CALL 01233 750354

# Hastingleigh Garage

***Motor Vehicle & Agricultural Engineer***

***MOTs, Welding***

***Vehicle bodywork repairs & spraying***

***Hastingleigh Yard, Hastingleigh, Ashford, Kent***

***Telephone 01233 750413***