

SWAT Archaeology – Archaeological Fieldwork Progress Report



Site Name:	Cottington Road, Cliffs End, Thanet
Site Address:	Cottington Road, Cliffs End, Thanet
Site Code:	CRT-EX-19
HER Reference:	-
Week Number:	7
Week Ending:	19/06/2020
Report Number:	7

Client:	WWMartin
Developer:	WWMartin
County:	Kent
Archaeological Officer:	Simon Mason

Author(s):	Dan Worsley
Origination date:	21/06/2020
Edited:	22/06/2020 DB
Circulation:	Simon Mason (KCC), WW Martin (Jay Bartling, Peter Clelford, Derek Anas, Trevor Codd and David Barker) and Dr Paul Wilkinson (SWAT Archaeology)

Archaeological Fieldwork Progress Form

1 WORKS PROGRESS

1.1 Site overview

- 1.1.1 Work this week consisted of the continuation of the hand excavation of Phase 1 North and South Site archaeology. On the North Site the focus has been on implementing the requested additional interventions within the Western Area of Phase 1, this has included the excavation of three additional interventions through the Trackway, which has shown that the parallel linear depressions containing a firm silt and flints continues along the entire section of the Trackway we have exposed in the strip. On the South Site the focus has been on understanding the broader chronology of the site instead of just initially focusing on getting small areas clear, we have been excavating the relationships between features across a broader area then implanting the profile slots needed for the SMS agreed sample size.
- 1.1.2 Features excavated on the South side have predominantly been medieval in date and show that there are several phases of large field systems or boundary ditches, all of which so far are truncated by the large medieval feature (LMF) that is situated in the middle of the site. An intervention, exploring the relationship with a pit and the large medieval feature, has revealed that it appears the LMF appears at the edges of the feature to consist of an upper fill that is sealing features beneath it such as large waste pits.
- 1.1.3 Two on site meetings have happened during the week, the first of which with Paul Wilkinson has resulted in the suggestion that the archaeological team could work optional longer hours in order to help with progress.
- 1.1.4 Drivers for the plant have been arranged for the North Site on Wednesday of next week to excavate the requested machine investigations slots by Simon Mason (see figure 1 for proposed interventions). These machine slots will include an investigation of the Silt deposit situated in the NW corner of Phase 1 North Site, the possible Colluvial spread, two 5-10m interventions through the Trackway, and two slots through the Large feature in the NE corner close to the axis of the hand auger boreholes.
- 1.1.5 The site was surveyed on Tuesday.

1.1.6 Wet weather conditions were seen this week, which resulted in a rain day on Wednesday as the archaeological strip was too wet and the facilities for wet weather paperwork were not adequate due to COVID-19 social distancing.

1.1.7 Our intentions are to have the Western half of Phase 1 North Site ready for sign off by Friday of next week, which after sign off will be handed over to WWMartin. We are then hoping to have the rest of Phase 1 North Site completed in 2-3 weeks depending on what the four SFB's produce and what the investigatory slots through the large features reveal.

1.2 Works Carried Forward

1.2.1 Continuation of the hand excavation of both Phase 1 areas.

1.3 Works Carried Out

1.3.1 Continuation of the hand excavation of both Phase 1 areas.

1.3.2 On the North site 15 features were excavated this week and three interventions through the Trackway.

1.3.3 On the South site 28 features were excavated this week. We have focused on excavating the archaeology along the Western LOE of the Strip, which has produced a series of possible segmented and intercutting prehistoric linear systems as well as some large wide medieval linear systems.

1.4 Forthcoming Works

1.4.1 Continuation of Phase 1 excavation.

2 Scheduled Meetings

2.1 Meeting on site with Paul Wilkinson (SWAT) on Tuesday:

Points discussed:

- Progress on site and optional longer work hours

2.2 Meeting with Paul Wilkinson and Dave Britchfield on Friday:

Points discussed:

- Progress on site and timeframes for completion of Western half of Phase 1 North Site.
- Density and complexity of archaeology of the South Site.

3 RESOURCES

3.1 SWAT Archaeology Personnel

3.1.1 SWAT Archaeology staff for this week included:

Project Director:	Dr. Paul Wilkinson	
Project Manager:	Dan Worsley BA MA	5 days
Project Supervisors:	Ali McKeever	5 days
	Matt Goulden	5 days
Site Surveyor:	Jonny Madden	1 day
Site Archaeologists:	Lesley Jones	4 days
	Neil Chaney	4 days
	Sonni Chamberlain	4 days
	Kevin Theobald	4 days
	Scott H	4 days
	E. Burrows	3 days
	V. Burrows	2 days
	A. Burrows	3 days
	Steve .T	4 days
	Chris Cole	4 days
	T. Brabham	
	Mark Foulds	1/2 day
	Daisy Foulds	

3.2 Sub-Contractors/Equipment Hire

NA

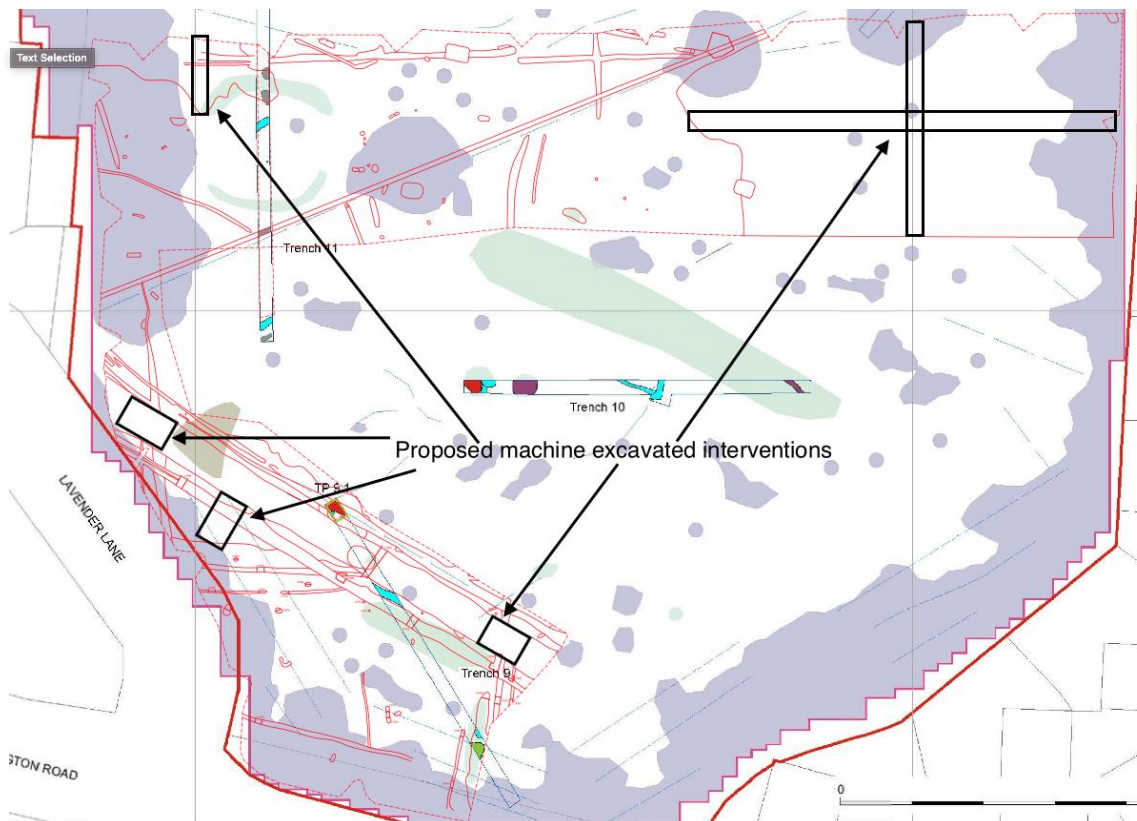

Figure 1 Proposed machine slots on Phase 1 North Site



Plate 1 Plan of [3213], [3222] and [3224]



Plate 2 Plan of [3228], [3231] and [3246]



Plate 3 Plan of intercutting linears and pits [3255], [3259] and [3263]



Plate 4 Plan of intercutting linears [3273], [3276] and Posthole [3278]



Plate 5 Additional slot through the Trackway showing the continuation of the parallel linear depressions in the base of the cut



Plate 6 Possible metalling in base of Trackway



634347.396
164265.766

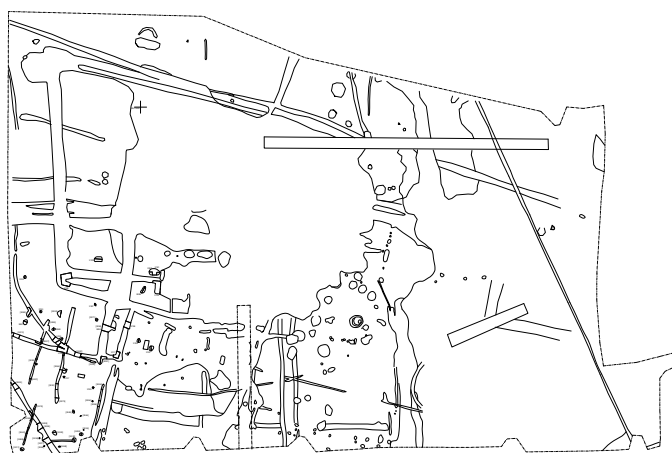
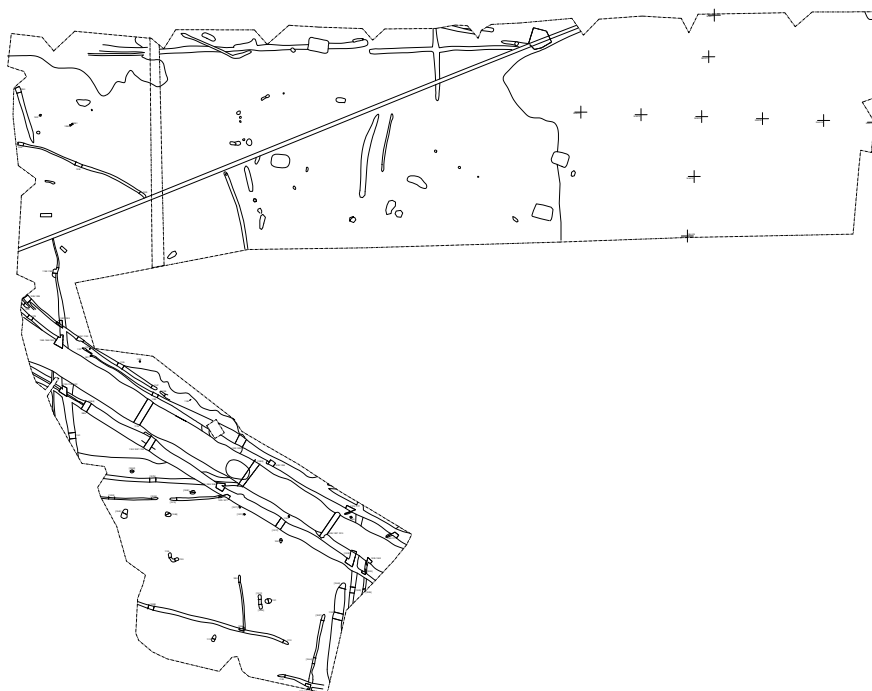

634173.849
163999.354

1:1250@A4

